

INSTALLATION INSTRUCTIONS

41-265R - FORMFUSION TRUNK LIGHT

RIDE WITH US

Founded in 1981 and located in Northern Wisconsin, Show Chrome believes that everyone deserves convenience, safety, and style. All of our products are designed by riders for riders to achieve just that.

Our products are designed and engineered in the USA and 50% of our products are manufactured in the USA: your investment in us and our community.

Please let us know how we can make your ride even better. Our team of riders in Wisconsin answers every customer call - always has and always will.

Sincerely,
Your Show Chrome Team
Rice Lake, WI, USA

RIDE WITH CONFIDENCE

These instructions are for both riders and dealers - written as a step-by-step guide with an eye for detail, just like our products. It's all part of your experience with Show Chrome, and we take that seriously.

LET US KNOW!

Please review the instructions before diving in, and if things get uncomfortable, don't hesitate. Reach out to us. We're here to help and offer direct, human customer service based in Rice Lake, WI, USA at 888-244-2453 anytime M-F from 8-5 Central Time. Ride safely, and ride often.

FUN FACT!

Under extreme conditions, the operating temperatures of modern braking components can average nearly 350°C, requiring that they need exceptional wear resistance, heat resistance, and stopping capabilities.

PRODUCT INFO

Product:
FormFusion Trunk Light

Part#:
41-265R

Fitment:
Can-Am RT/LTD 2020+, F3 T/LTD 2018+

INCLUDED

- FormFusion Trunk Light (2x)
- Male Spade Connector (8x)
- T-Tap Connector (8x)
- Adhesive Backed Flat Cable Holder (20x)
- Isopropyl Alcohol Wipe (2x)
- Adhesion Promoting Wipe (2x)
- Pigtail (2x)
- Wire Ties (6x)
- Extension Harness (2x)

TOOLS NEEDED



- 1** **RT and F3:** If you have a driver backrest installed, it must be removed to allow the passenger seat to be removed in the upcoming steps.

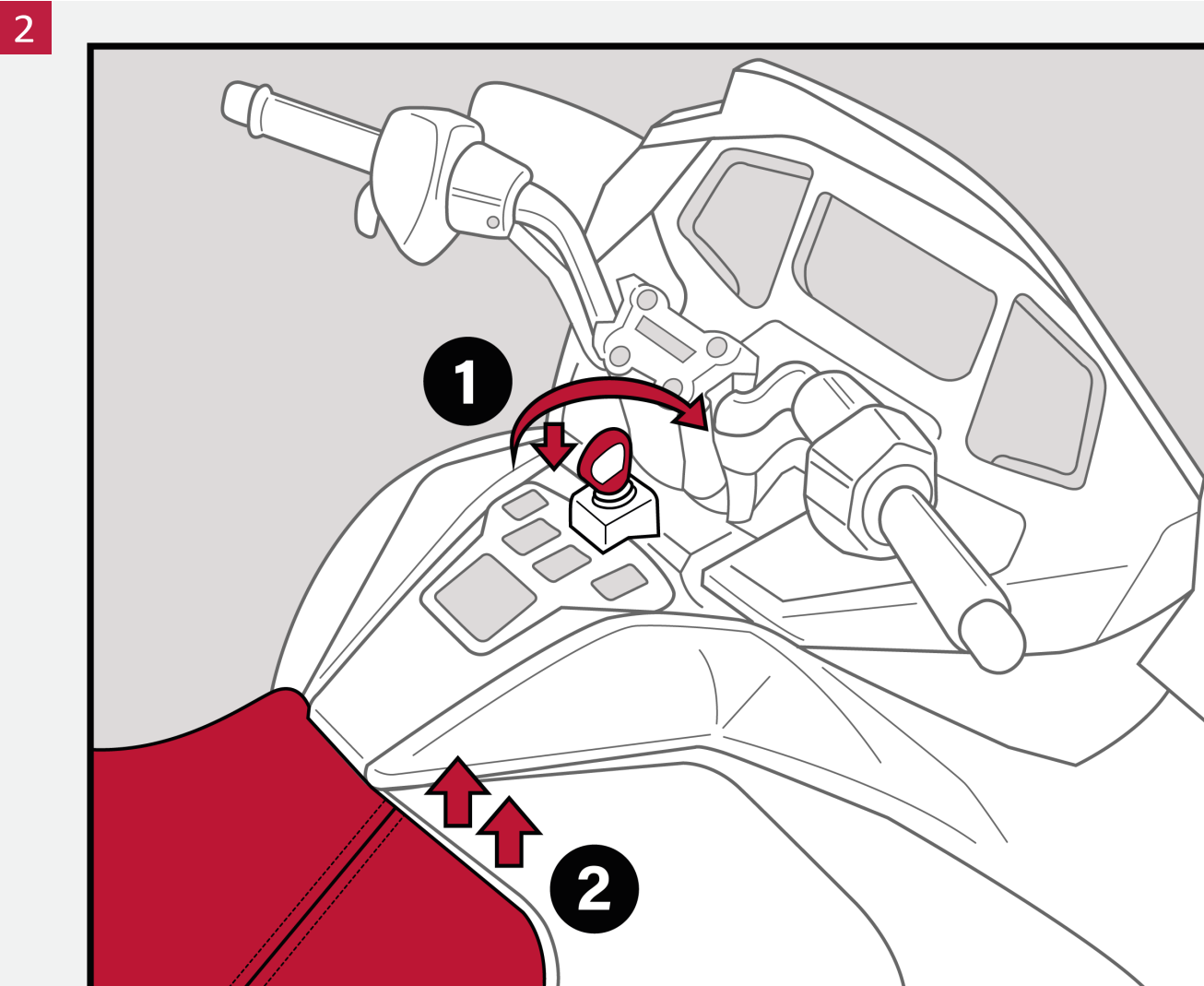

RT Only: Release the driver seat latch by pushing in on the key & turning it clockwise. Lift up the front of the driver seat to open it.

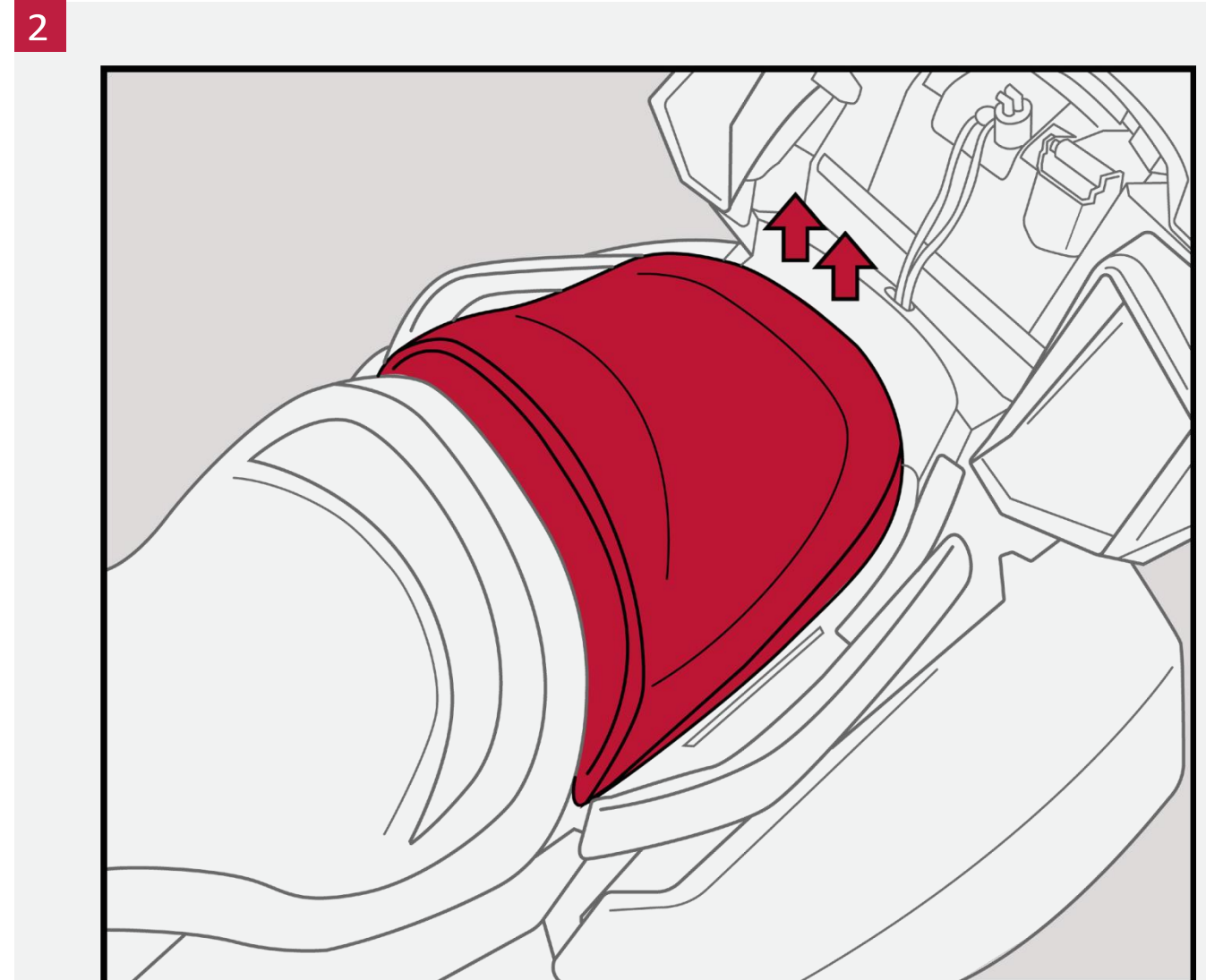

F3 Only: Release the passenger seat latch by pushing in on the key & turning it clockwise. Lift up the back of the seat to remove it.

3

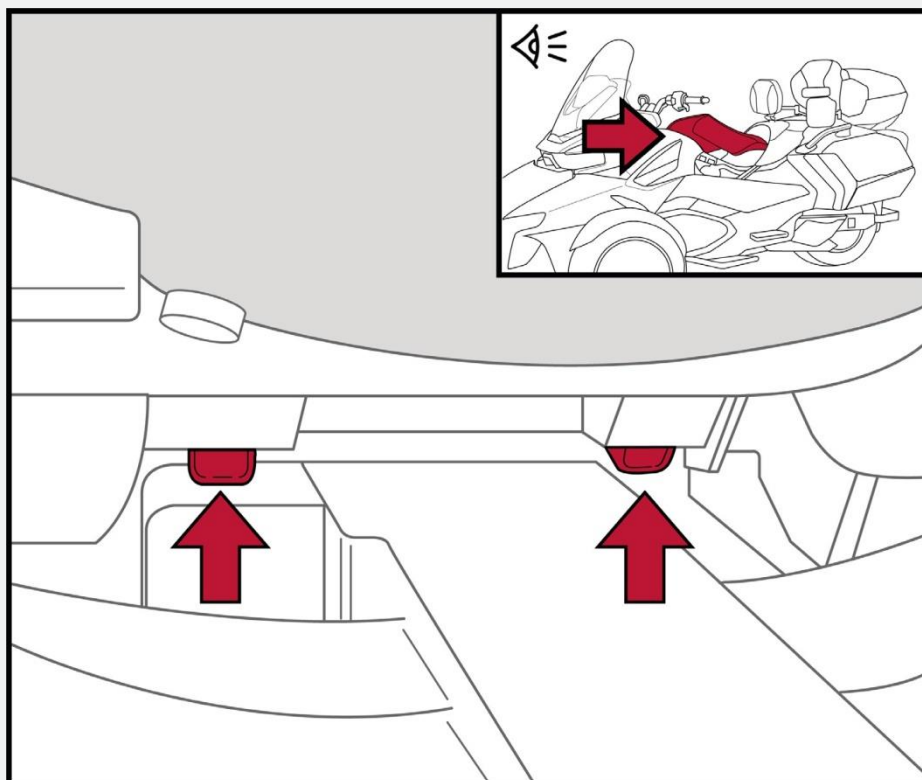

RT Only: Press the two tabs securing the front of the passenger seat from under the driver seat and lift up slightly to release (Located at the front bottom of the passenger seat under the driver seat).

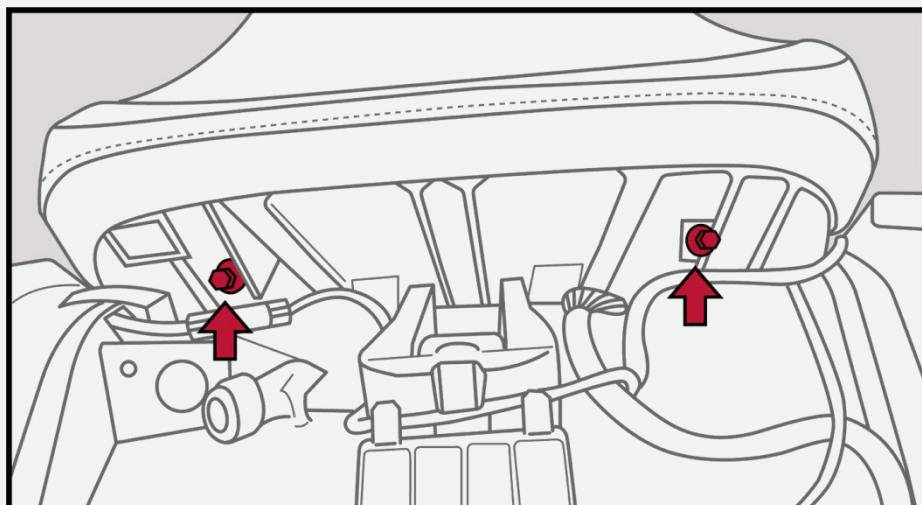

F3 Only: Using a 3/8" DRIVE RATCHET, 10MM SOCKET and a 6 INCH EXTENSION, remove the bolts holding the drivers seat.

4

RT Only: Close the driver seat to allow you to lift the front of the passenger seat up past the driver seat and slide it forward to loosen it.

F3 Only: With the hardware removed from the previous step, completely remove the driver's seat. Skip to step 5.

4a

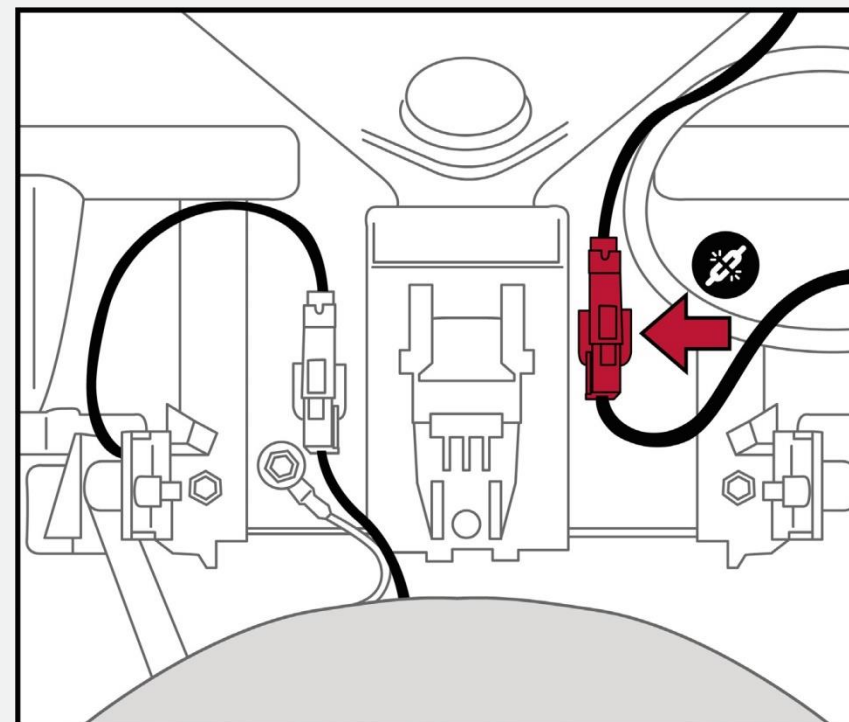

RT Only: Disconnect the passenger seat wire harness. Set the seat aside on a clean surface or towel.

5

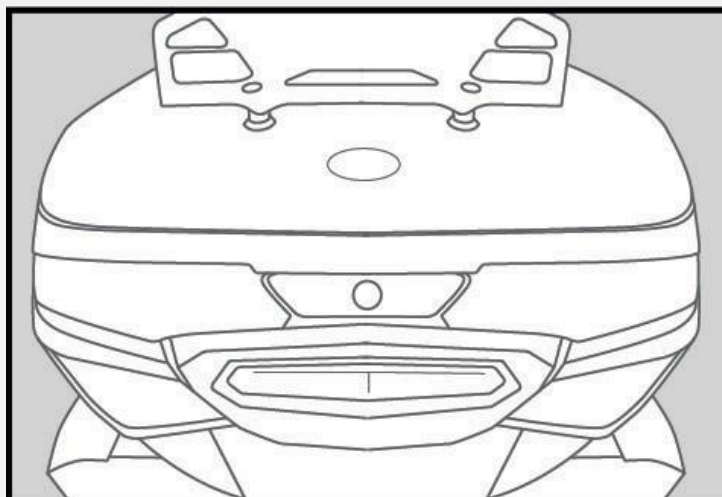

Some RTs and F3: If your Spyder has the stock OEM trunk lid fillers in the cavities where the FormFusion lights will be installed, remove them using fish line or any other item that will facilitate the removal process. After removing both inserts, remove the entire double sided tape residue left on the surface of the trunk.

6

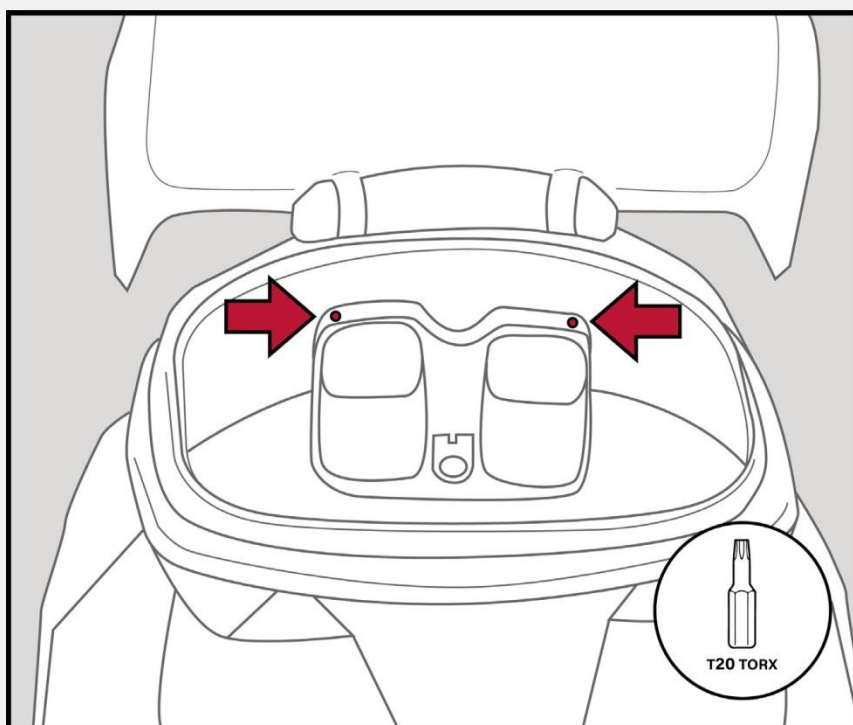

RT and F3: Open the trunk lid, and from inside the trunk, use a T20 TORX to remove the two screws securing the passenger backrest pad.

7

RT and F3: Close the trunk lid.

8

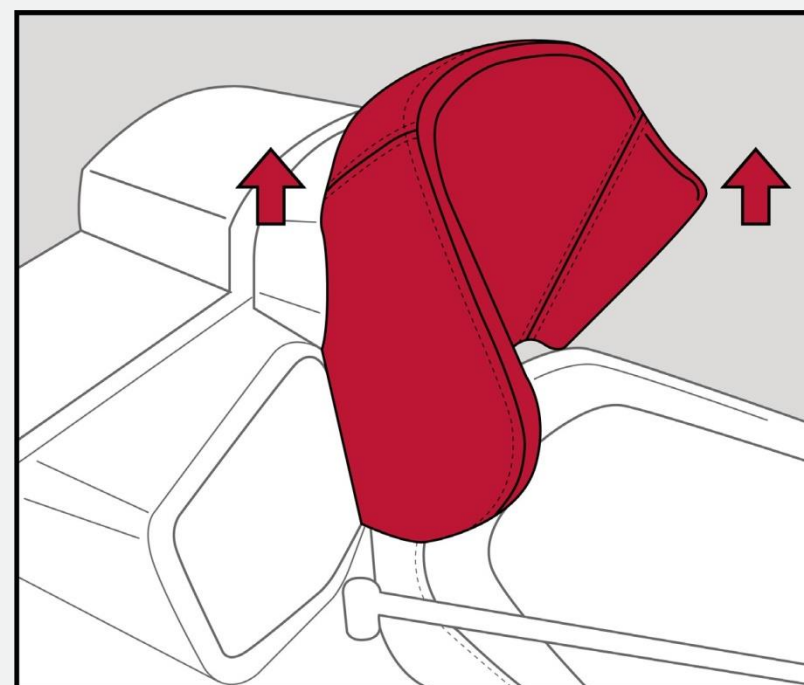

RT and F3: Carefully slide the passenger backrest pad straight up and forward to remove it.

Set aside your backrest pad on a clean towel or surface to avoid damage.

9

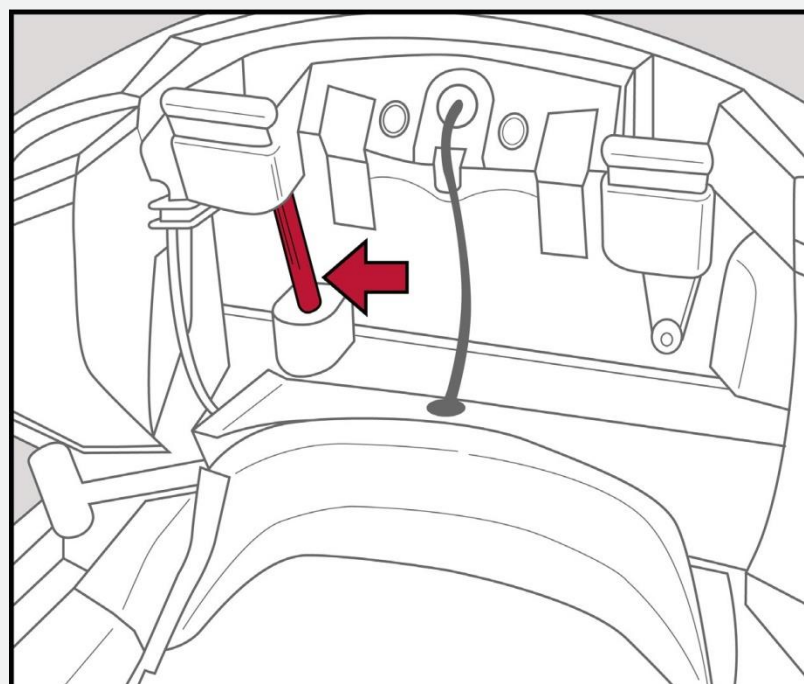

RT and F3: Now, with the exposed area where the backrest was, locate the trunk shock.

10

RT and F3: Open the trunk lid.

11

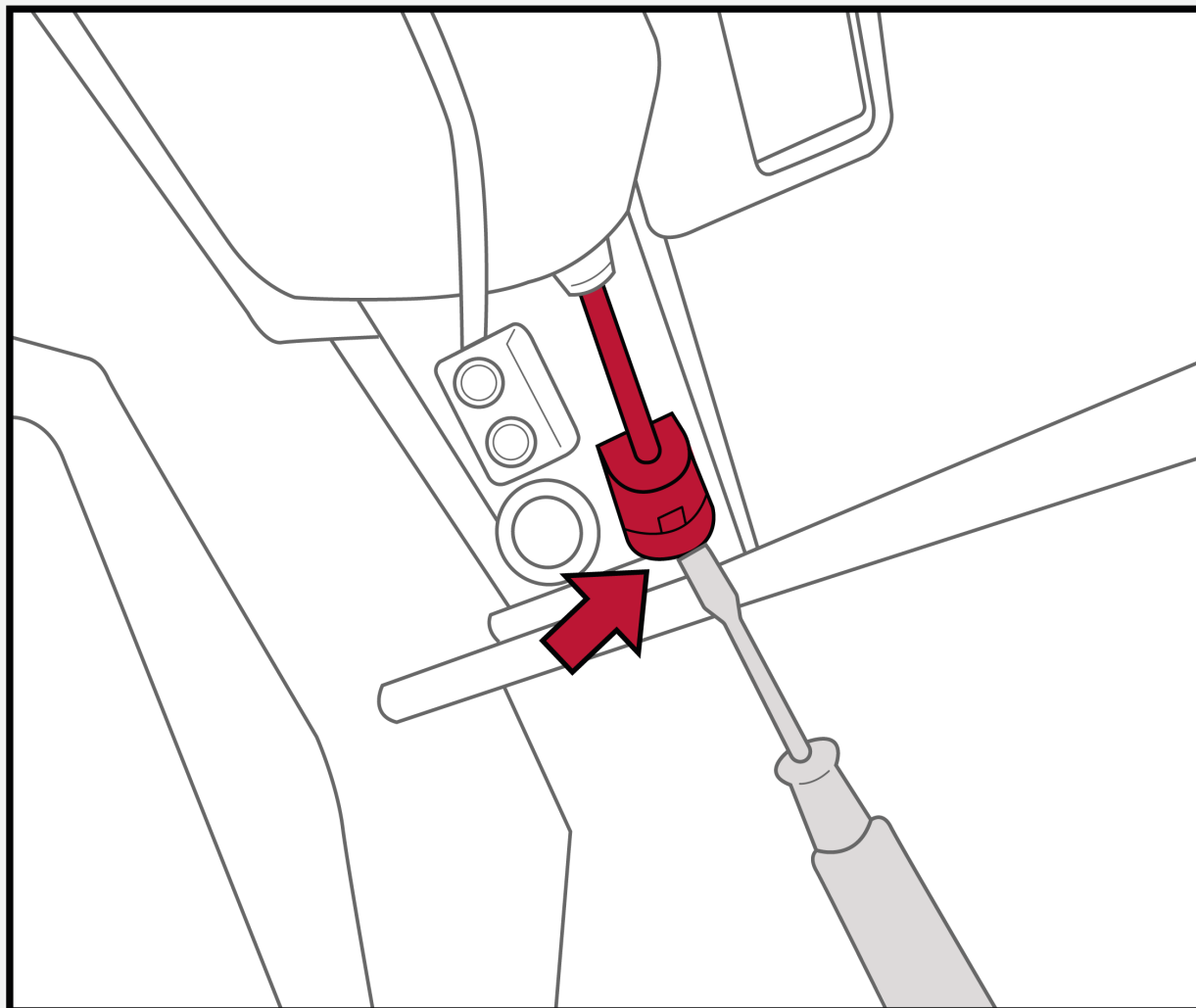

RT and F3: Using a FLAT SCREWDRIVER while supporting the lid, release (pry straight out) the metal clip securing the bottom of the trunk shock.

NOTE: It is essential to hold the trunk lid when removing the trunk shock to avoid any damage to the Spyder or injury to the installer.

12

RT and F3: Close the trunk lid.

13

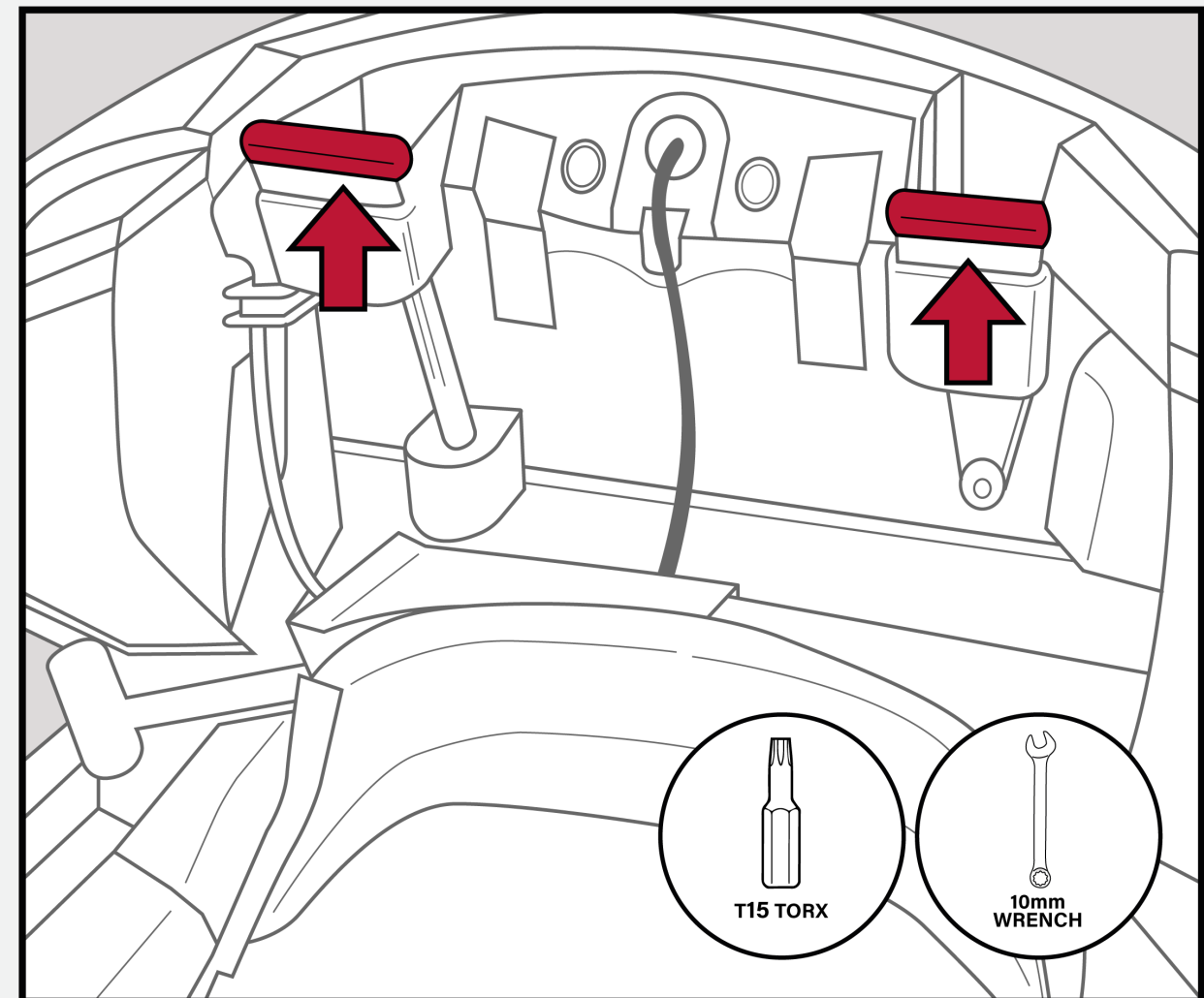

RT and F3: With the trunk lid closed, remove the trunk lid hinge pins using a 10MM WRENCH to hold the bolt head in place and a T-15 TORX to remove the screw at the opposite end.

NOTE: The left and right hinge pins are different sizes. This will become relevant when reinstalling the hinge pins in a later step.

14

RT and F3: Remove the trunk lid from the Spyder.

15

RT and F3: Place the trunk lid with the inside facing up on a clean, soft surface to avoid scratching.

16

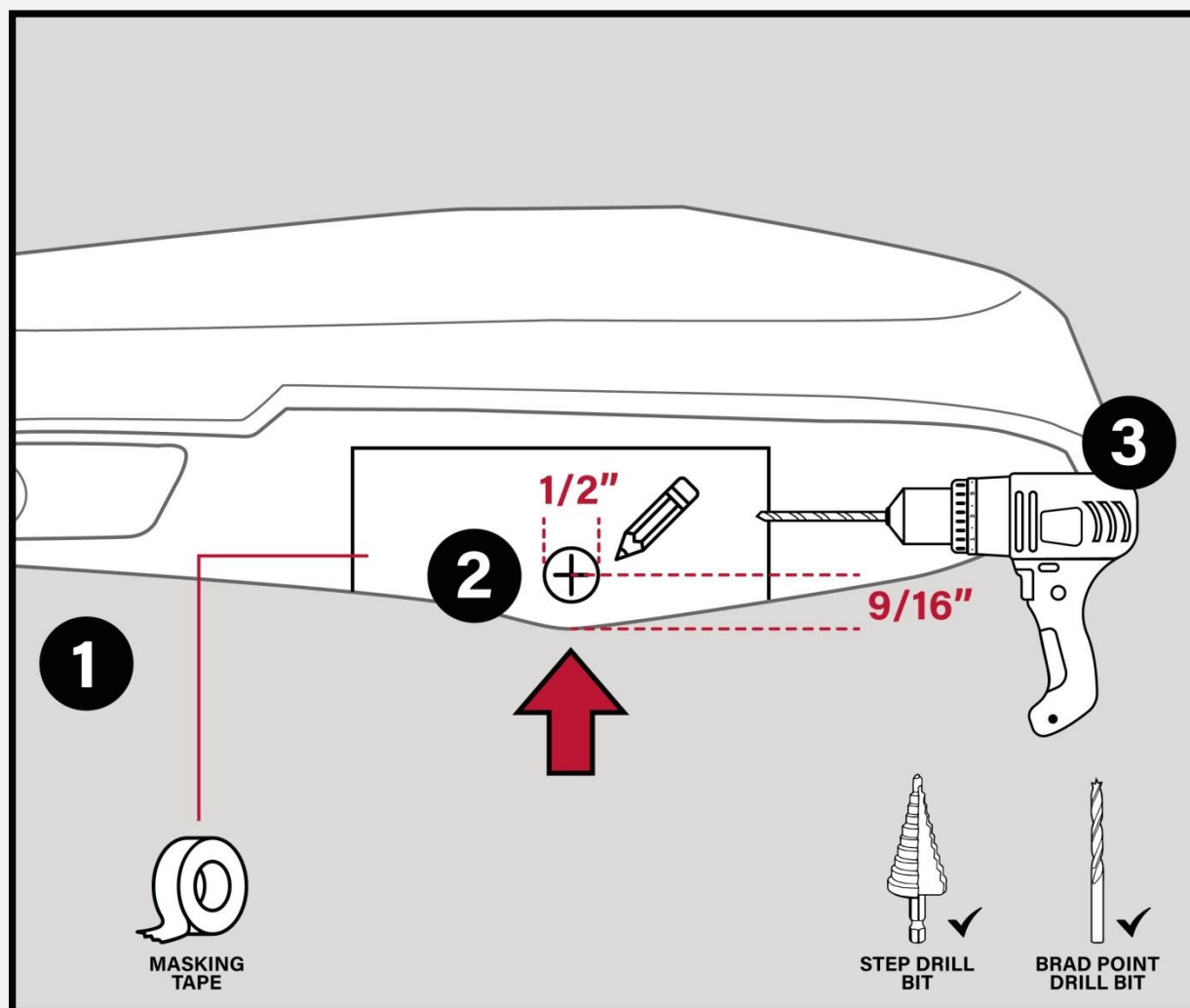

RT and F3: Flip the trunk lid so the finished surface faces up and the BRP logo faces you. We will start by focusing on the right-hand side of the trunk to begin the installation of the left side trunk light. Place a piece of MASKING TAPE on the trunk lid, as shown above.

- Next, locate what we call “the sharp end” on the trunk lid.
- Using a ruler, make a vertical mark in the masking tape beginning at “the sharp end” described above and extending 2 inches long.
- Using the 2-inch-long vertical mark as a guide, measure 9/16” from the sharp end up and place a dot.
- The dot you marked becomes the center point of where to drill.

17

RT and F3: Hold the right side trunk light up to the trunk in position to verify that the wiring lines up with corresponding marks on the trunk before drilling.

18

RT and F3: After confirming that the marks made in step 16 align adequately with the wire coming out of the right side trunk light, proceed to drill the 1/2” hole through the trunk lid centered on the mark.

NOTE: At Show Chrome, we recommend using a Step Drill Bit or Brad Point Drill Bit for drilling plastic panels to avoid damaging the panel.

19

RT and F3: Remove the masking tape and any burs from drilling the hole

20

RT and F3: Repeat steps 16-19 on the left side of the trunk lid.

21

RT and F3: Clean the outside surfaces of the trunk lid, where the trunk lights will be mounted thoroughly with the ISOPROPYL ALCOHOL WIPE provided. Let the trunk lid dry completely before continuing.

22

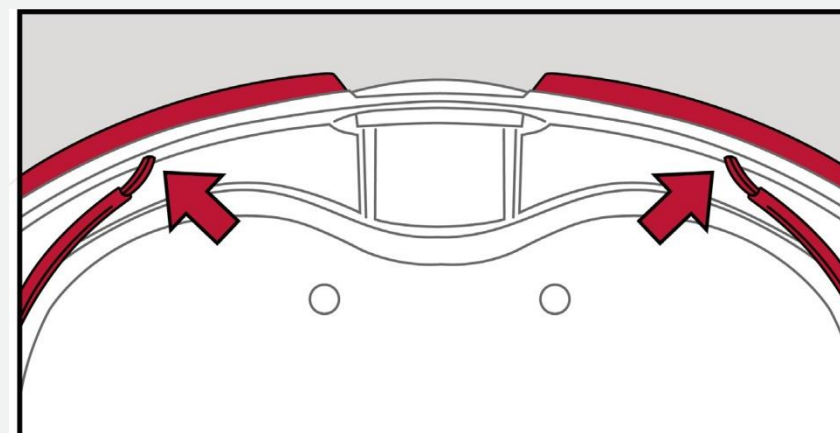

RT and F3: Starting on the left side, feed the connector end of the left side trunk light cable through the 1/2” hole outside the trunk and pull the slack through.

23

RT and F3: Place the left side trunk light into position and align it to see how it will look before removing the backing tape.

24

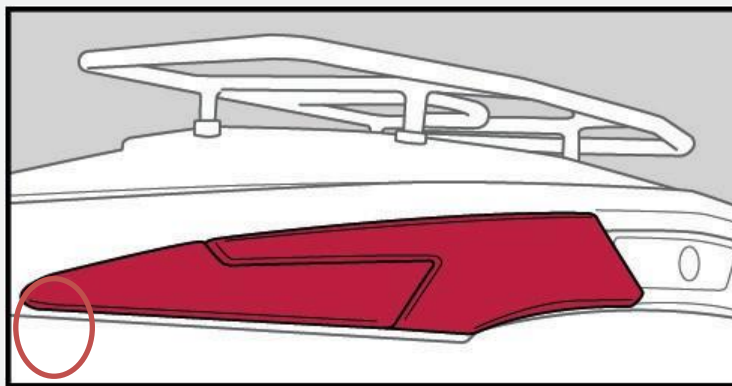

RT and F3: After confirming the appropriate fitment, wipe the surface where the trunk light will be mounted with the ADHESION PROMOTING WIPE provided. Once surface is dry, remove the backing tape from the left side trunk light and carefully press it into place on the trunk lid.

NOTE: Line up the circled tip of the light to the trunk lid's contour and stick the light from the outside towards the inside portion of the lid accordingly.

25

RT and F3: Repeat steps 21-24 on the right side of the trunk lid to install the right side trunk light.

26

RT and F3: After installing both trunk lights, clean the inside parameter of the trunk lid and inside cavities of the hinges using one of the ISOPROPYL ALCOHOL WIPES provided and let dry completely before continuing.

27

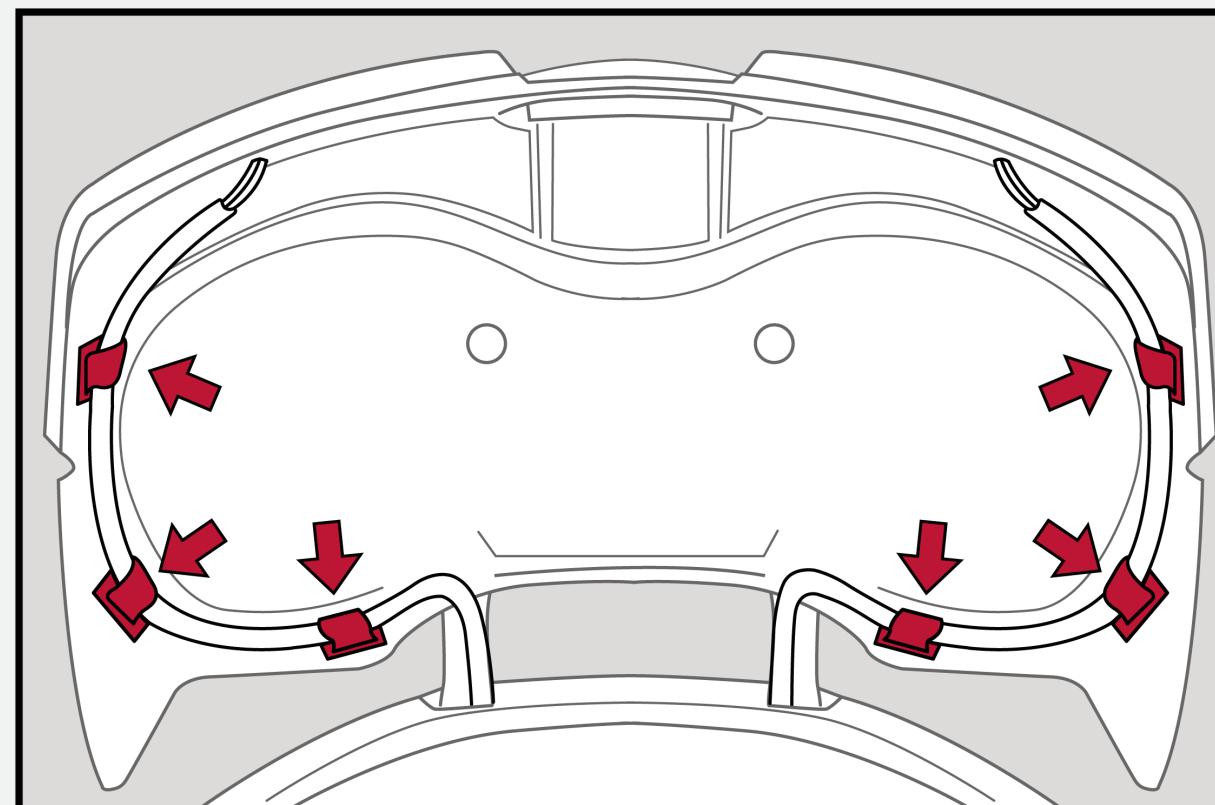

RT and F3: Once the inside of the trunk lid is dry, place trunk lid in place where it will eventually be fastened to, but leave loose at the moment and ADHESIVE BACKED FLAT CABLE HOLDERS at the outer edge as desired.

NOTE: We have provided extra ADHESIVE BACKED FLAT CABLE HOLDERS so you may use as many as applicable.

28

RT and F3: Cut two of the supplied ADHESIVE BACKED FLAT CABLE HOLDERS flush with the top clip portion, utilizing scissors.

NOTE: The modified ADHESIVE BACKED FLAT CABLE HOLDERS will be utilized to route the cables appropriately.

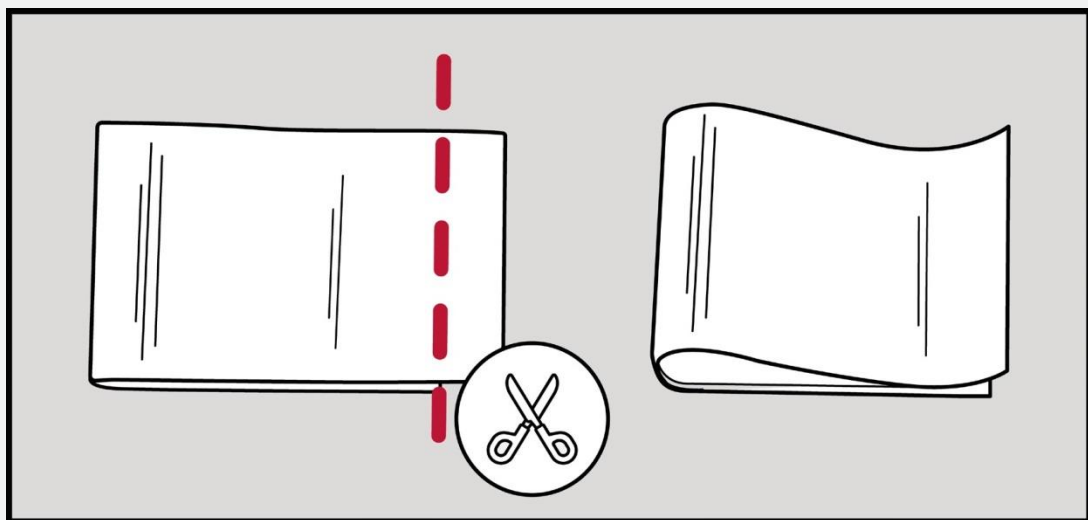

29

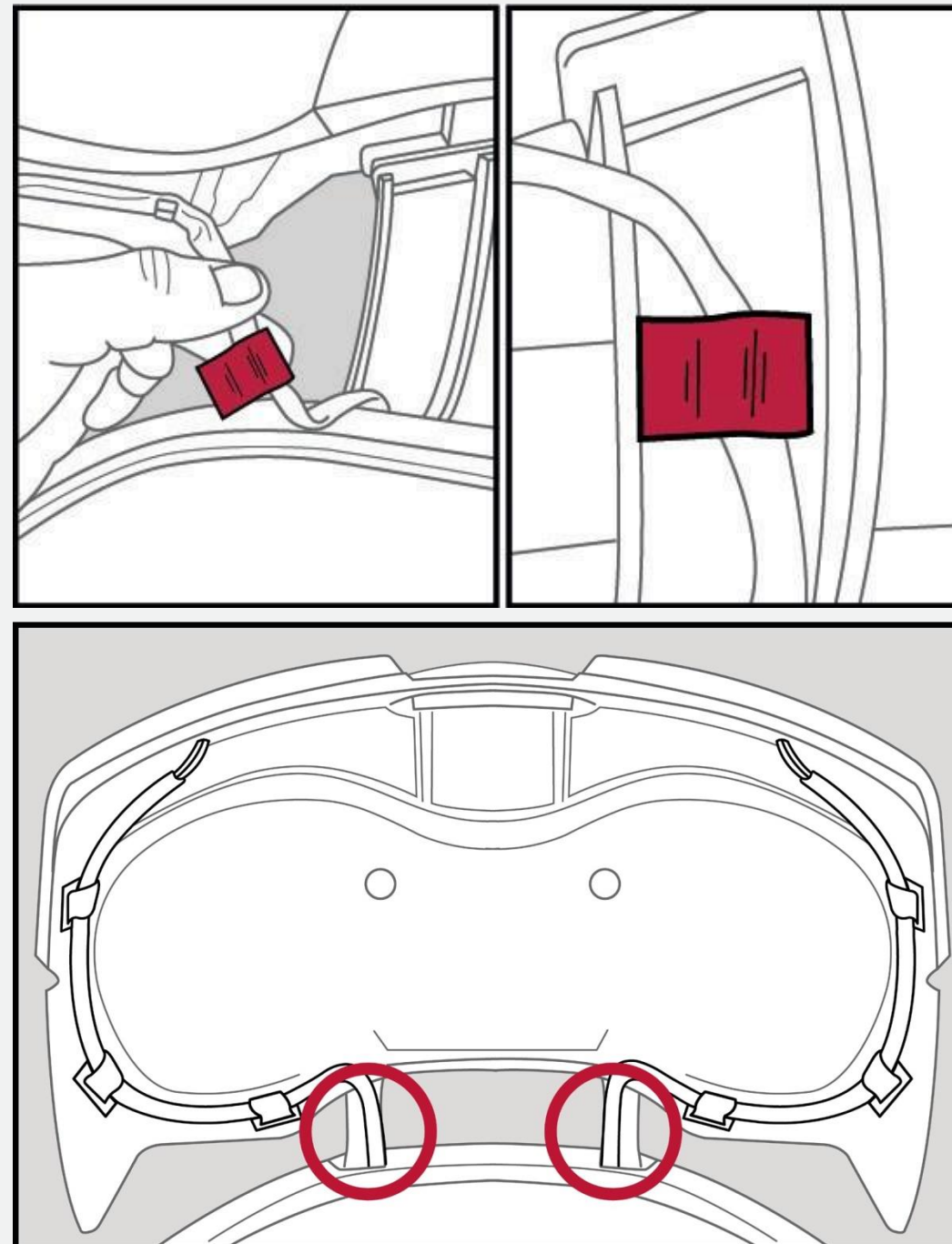

RT and F3: Place the modified ADHESIVE BACKED FLAT CABLE HOLDER to the left light's cable, peel away the backing and stick the holder to the hinge cavity.

30

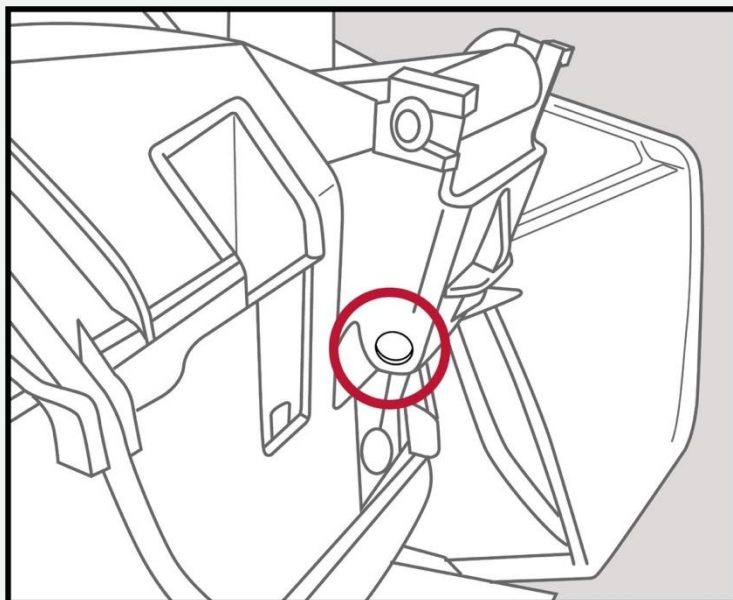

RT and F3: On the left side of the Spyder, drill a 1/2" hole on the section seen, this will allow you to feed you connector through the trunk lid's hinge onto the passenger's backrest area.

31

RT and F3: Repeat step 29 on the right side of the Spyder.

32

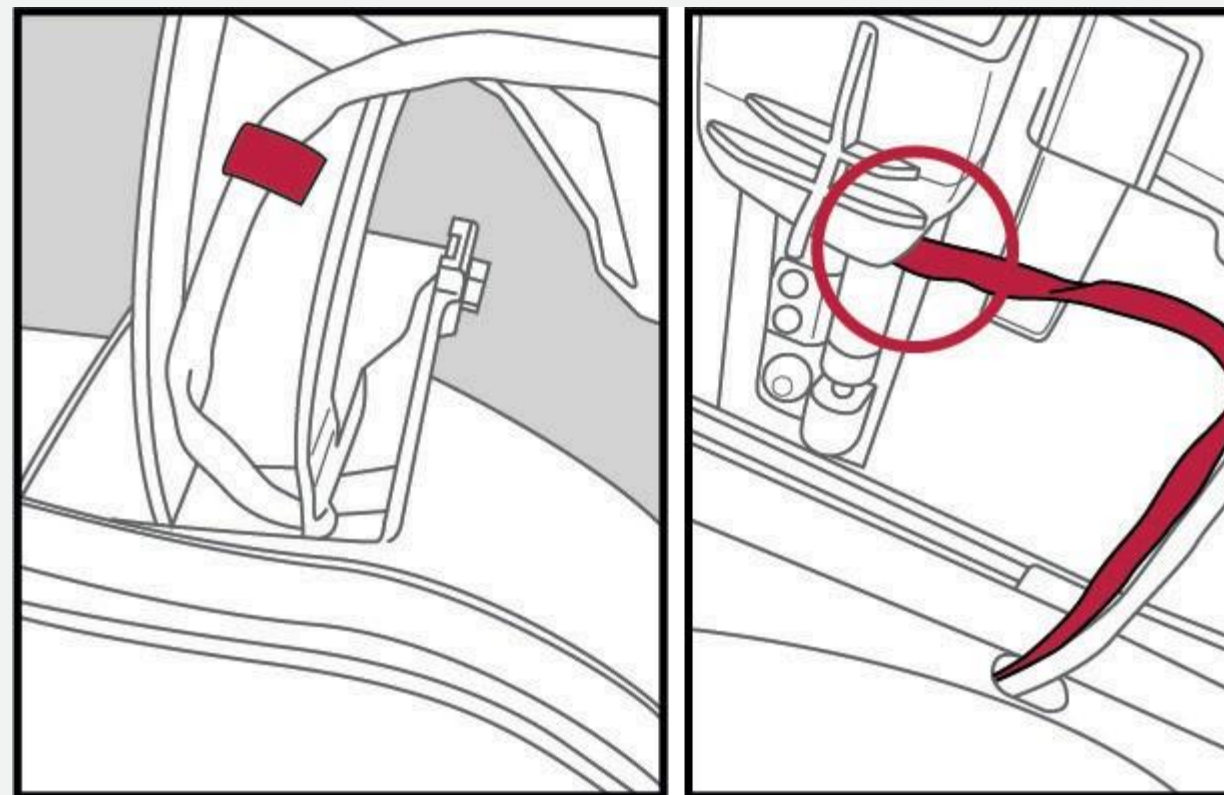

RT and F3: Feed your right light's cable along the trunk lid hinge and to the backrest panel area, similarly to the left side, but use the cutout by the trunk shock to feed your cable towards the passenger seat area.

33

RT and F3: After installing and routing both trunk lights, repeat steps 11-13 in reverse order to install the trunk lid on the trunk and place the trunk lid shock in position

34

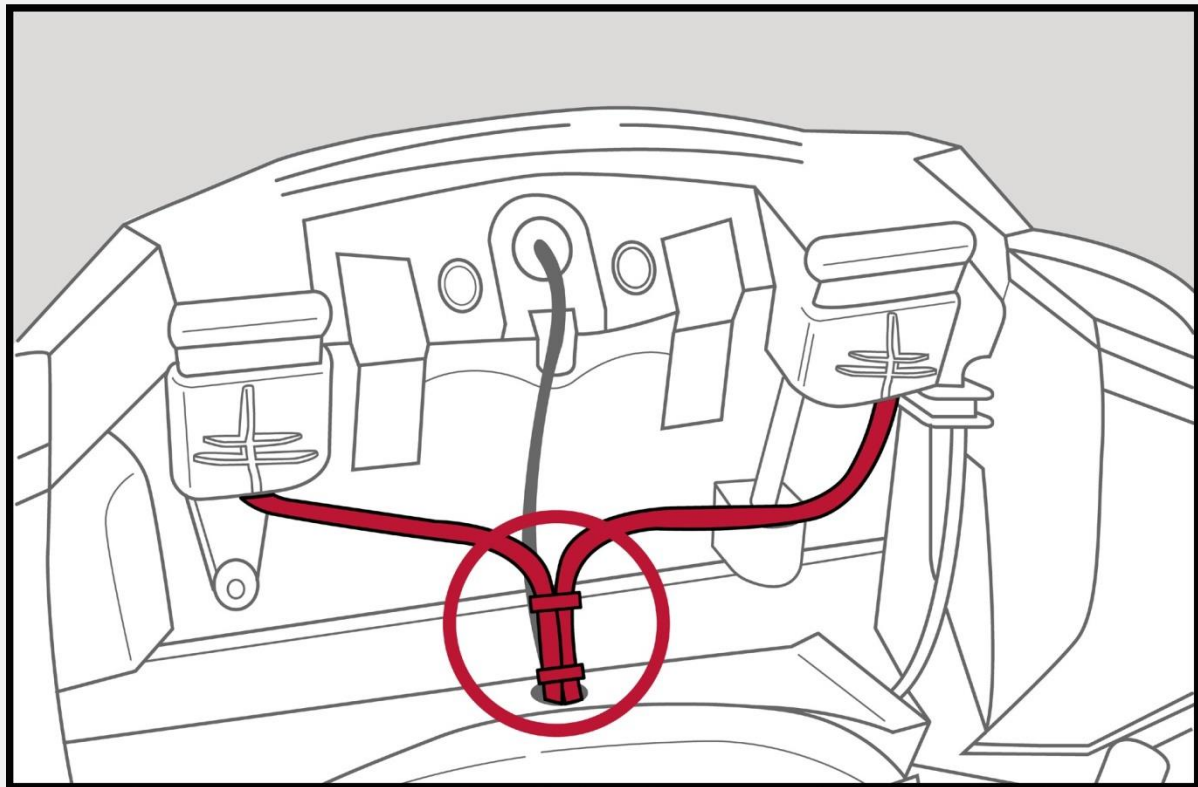

RT and F3: After securing your trunk lid to the Spyder, route both cables towards the middle stock OEM harness and down through the middle opening of the rear shroud panel. Use WIRE TIES to secure the FormFusion lights cables to the stock OEM harness.

35

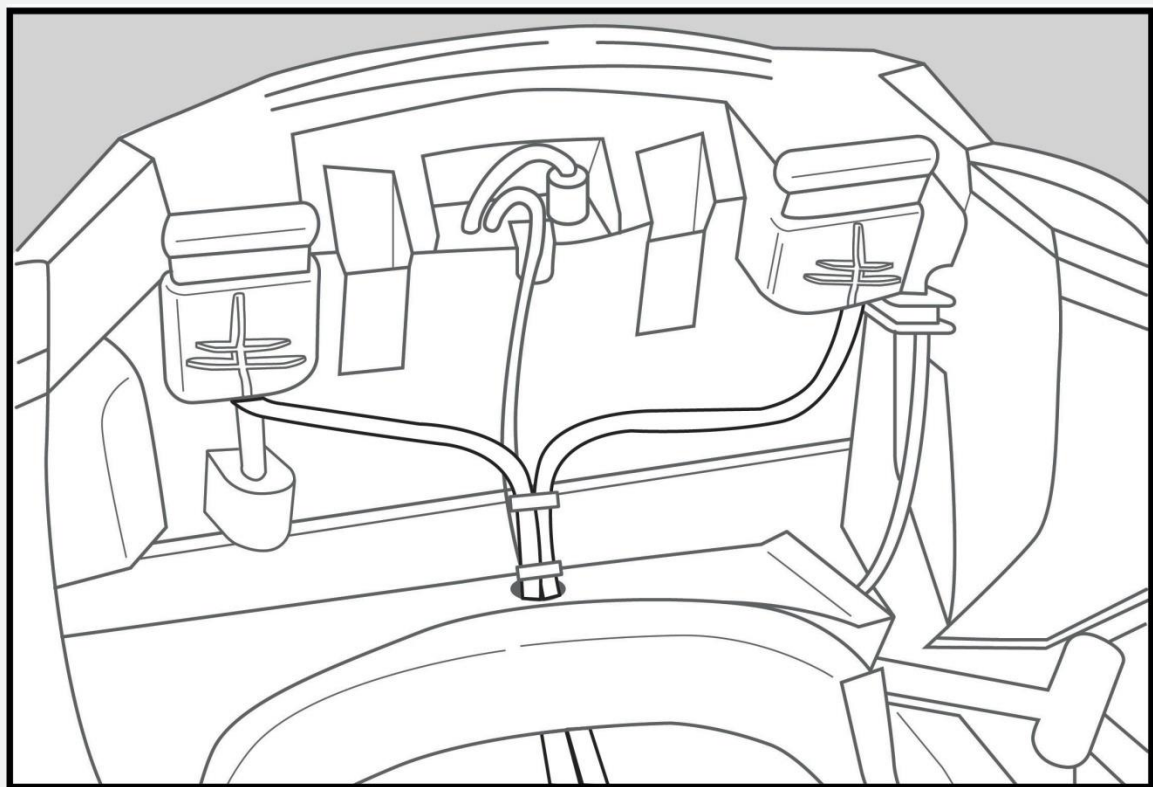

F3 Only: Grab the connector ends of the cables you fed through the middle opening of the rear shroud panel, and pull slack towards the passenger seat area. Skip to step 36.

35a

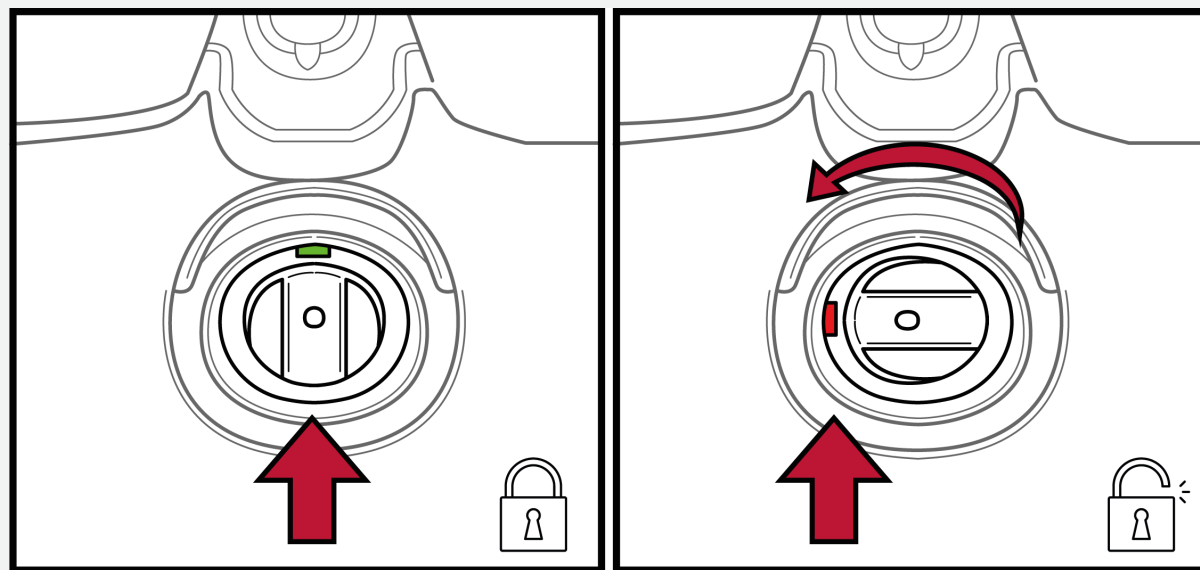

RT Only: With your cables hidden underneath the trunk area, you will unlatch the trunk compartment by turning the locking mechanism on the bottom surface of the trunk counter-clockwise 90 degrees.

NOTE: It helps to lift the trunk compartment to get the locking mechanism to unlock from the Spyder.

35b

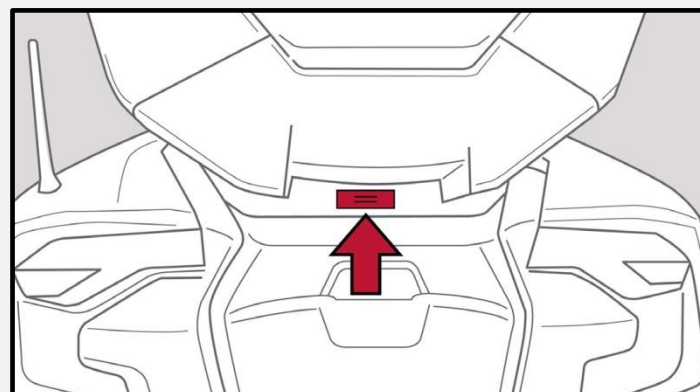

RT Only: The trunk compartment has a safety locking mechanism that, at this point, it will not allow you to tilt the trunk compartment forward any further; therefore, you will have to push the locking button seen above. This will enable you to fully unlock the trunk compartment and access the bottom side.

35c

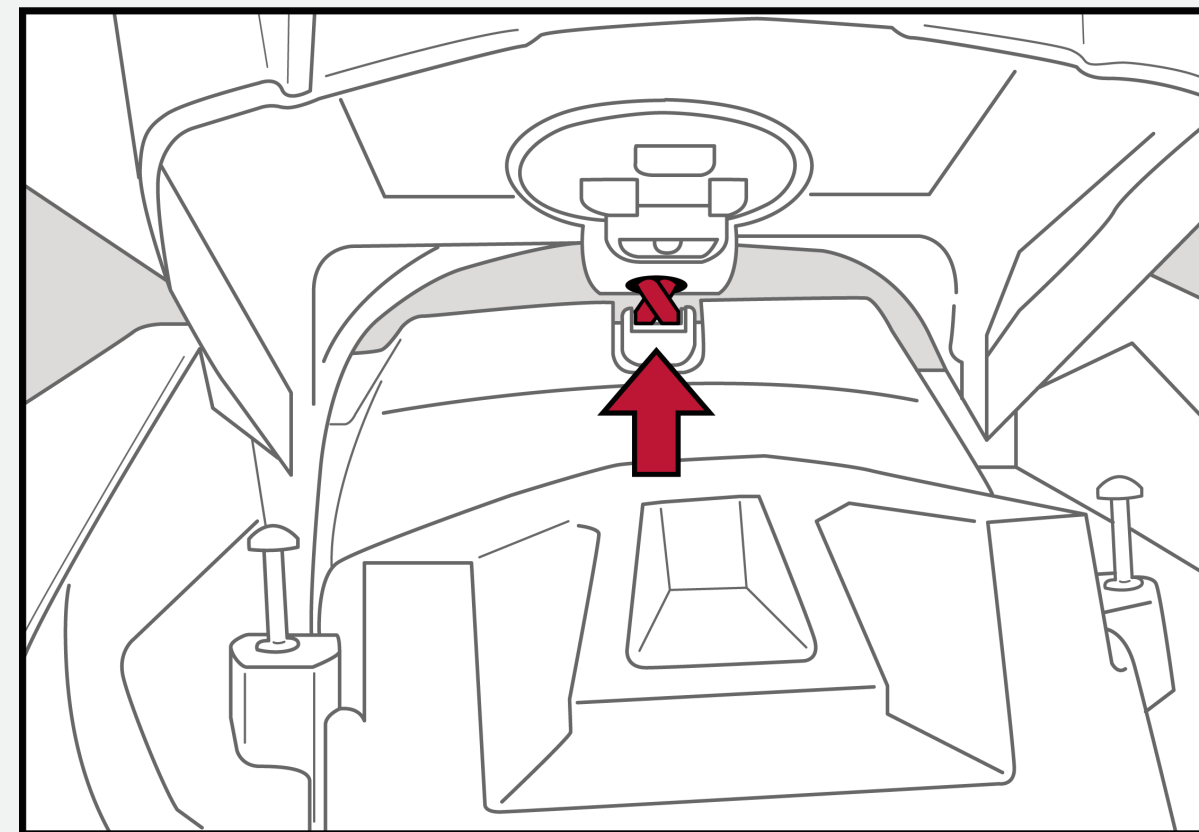

RT Only: With the trunk compartment tilted towards the front, locate the trunk light connectors and cables and feed them through the middle opening of the rear shroud panel towards the driver's seat.

36

RT and F3: At this point, you have completed most of the wire routing and trunk light installation. From here, you will have two options:

1. If you have opted to buy the basic Show Chrome kit for 41-265R and wire the lights yourself, follow steps 37-43 to wire your trunk lights appropriately.
2. If you have purchased the Show Chrome Plug N' Play Wire Harness 41-265WI, follow steps 44-47.

INSTALLING TRUNK LIGHTS BY T-TAPING INTO TAIL HARNESS

37

RT and F3: Identify the pigtail connectors supplied with the basic kit of 41-265R.

38

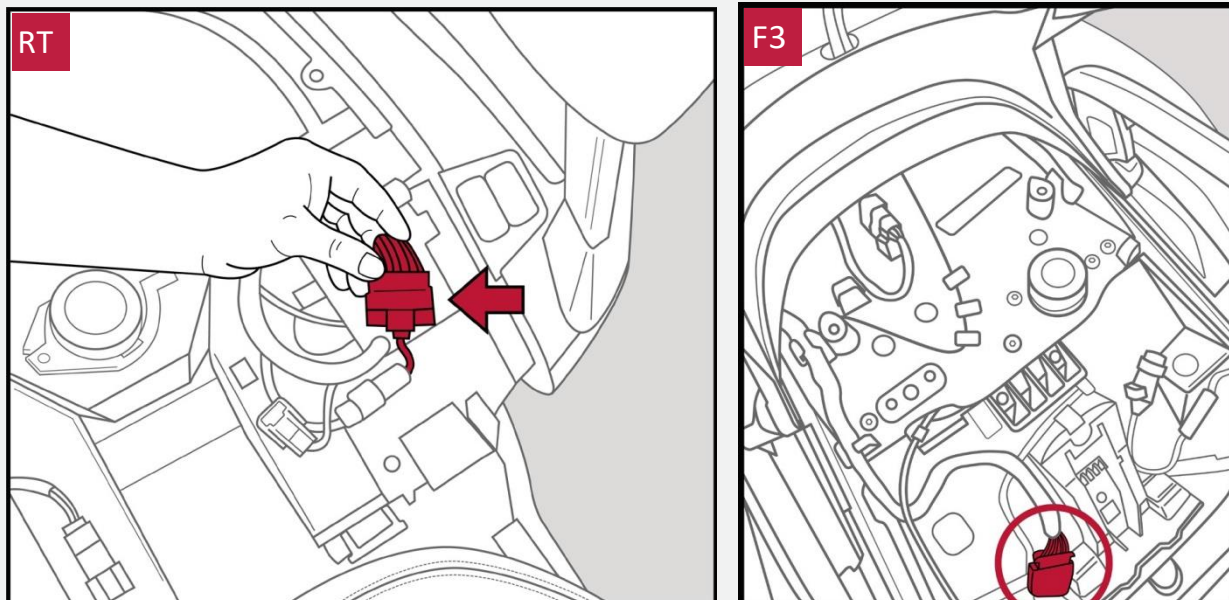

RT and F3: Locate the stock OEM tail harness location on the (left side for RTs) (right side for F3s) where the passenger seat is usually located.

NOTE FOR RTs: You might need to pull the tail harness into the outer surface as it may be tucked in the opening.

39

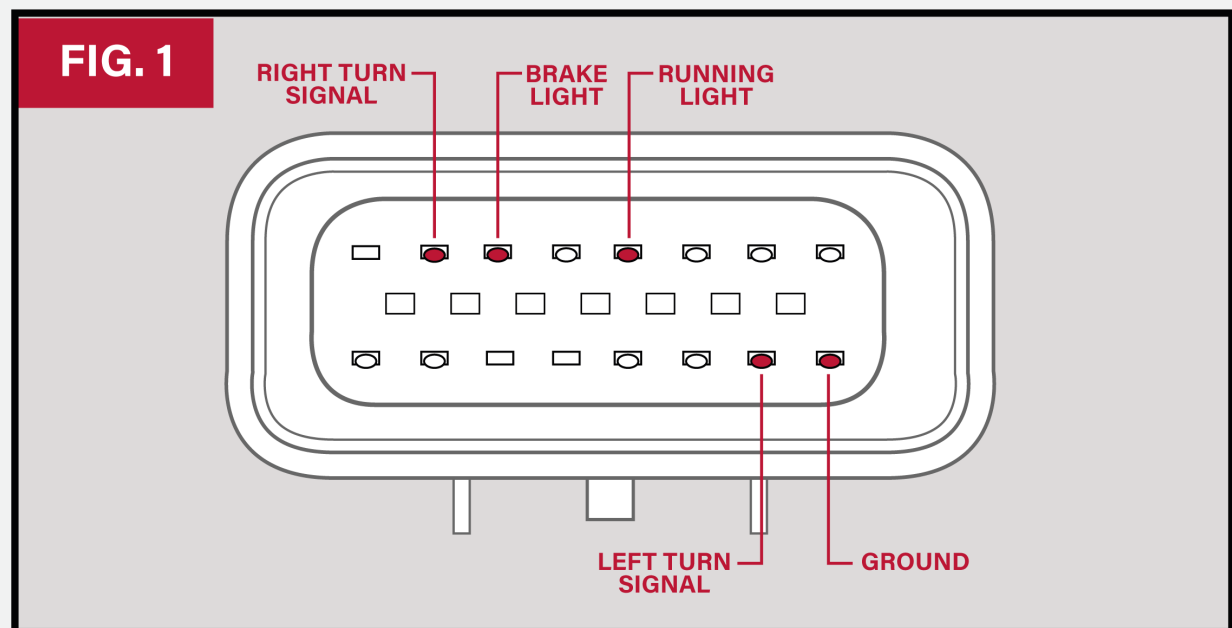

RT and F3: Unplug the stock OEM tail harness, utilize the T-TAP CONNECTORS provided, and T-tap into the wires coming off the pins labeled above.

NOTE: Wire colors can differ across Spyder models and years. To help you ensure you understand the functionality of your wires before T-taping, Show Chrome has created a guide in FIG. 1 above. Just T-tap to the wires coming from the back end of the pins, as indicated in this step.

40

RT and F3: Install SPADE CONNECTORS to all the raw wires in both pigtails.

41

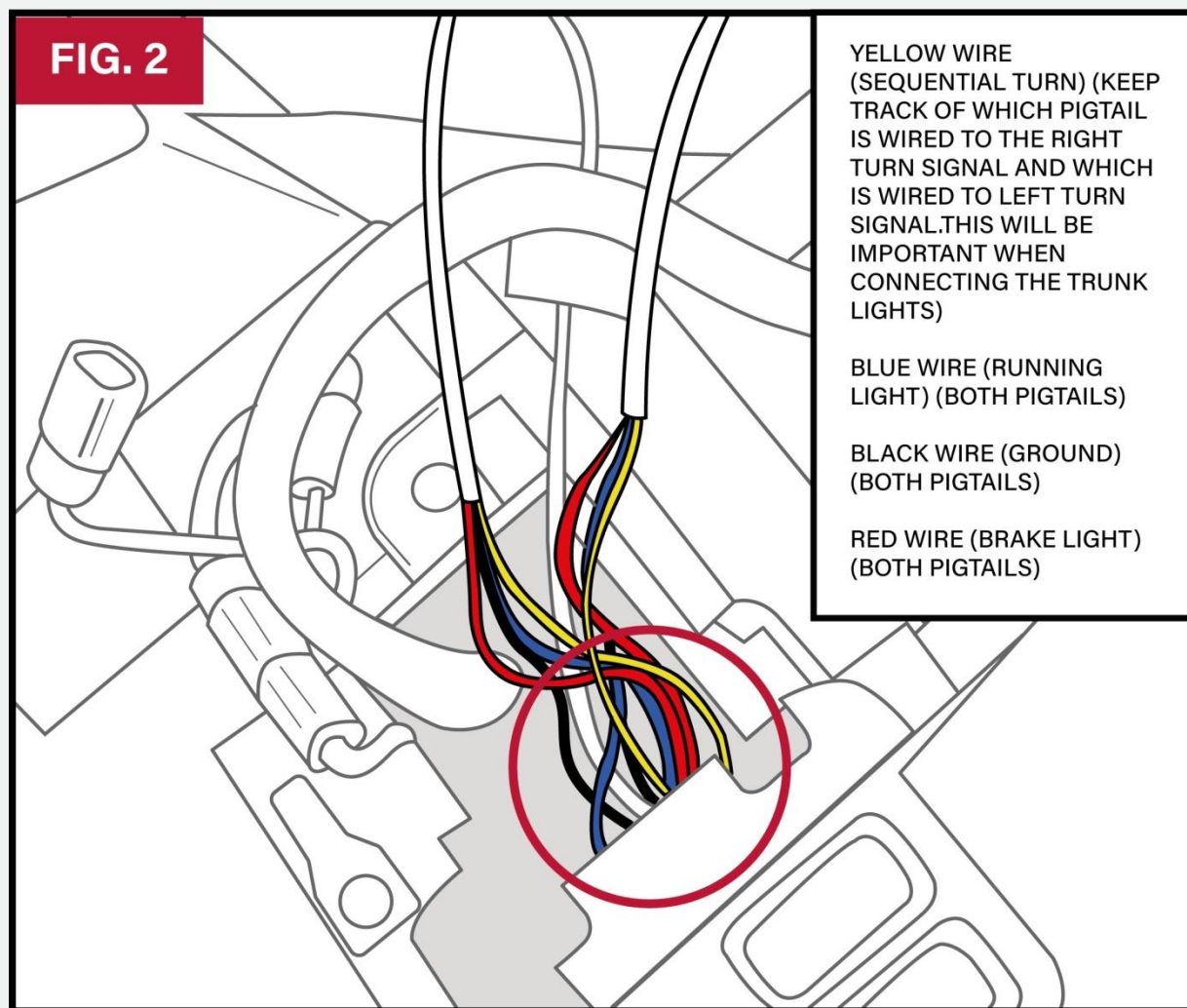

RT and F3: Plug in the SPADE CONNECTORS to the T-TAP CONNECTORS accordingly, referencing FIG. 1 and FIG. 2 will allow you to determine where to plug each connector.

NOTE: *Wires from pigtails are as follows:*

Yellow Wire = Sequential Turn (verify to plug in the appropriate SPADE CONNECTOR to the right T-TAP CONNECTOR as this will ensure correct signaling)
 Blue Wire = Running Light
 Red Wire = Brake Light
 Black Wire = Ground

42

RT and F3: Repeat the previous step on the right side for the right trunk light.

43

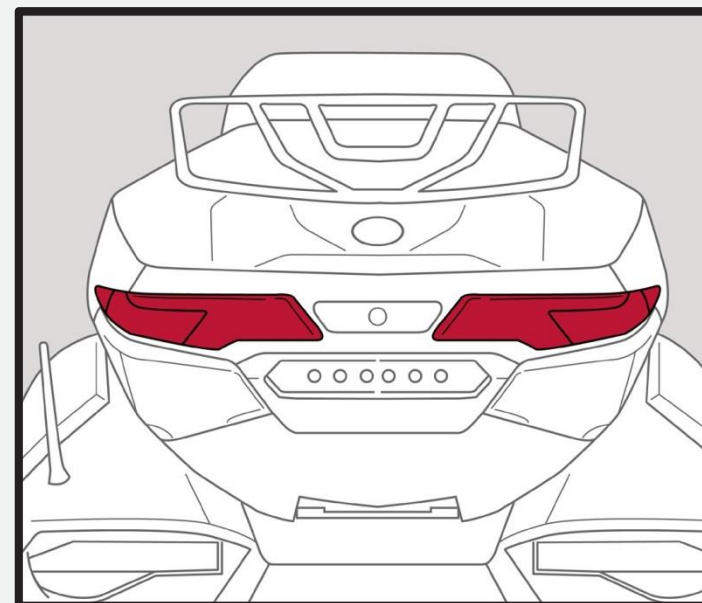

RT and F3: Test the trunk lights before putting the Spyder back together to verify the correct function.

INSTALLING TRUNK LIGHTS WITH SHOW CHROME PLUG N' PLAY WIRE HARNESS 41-265WI

44

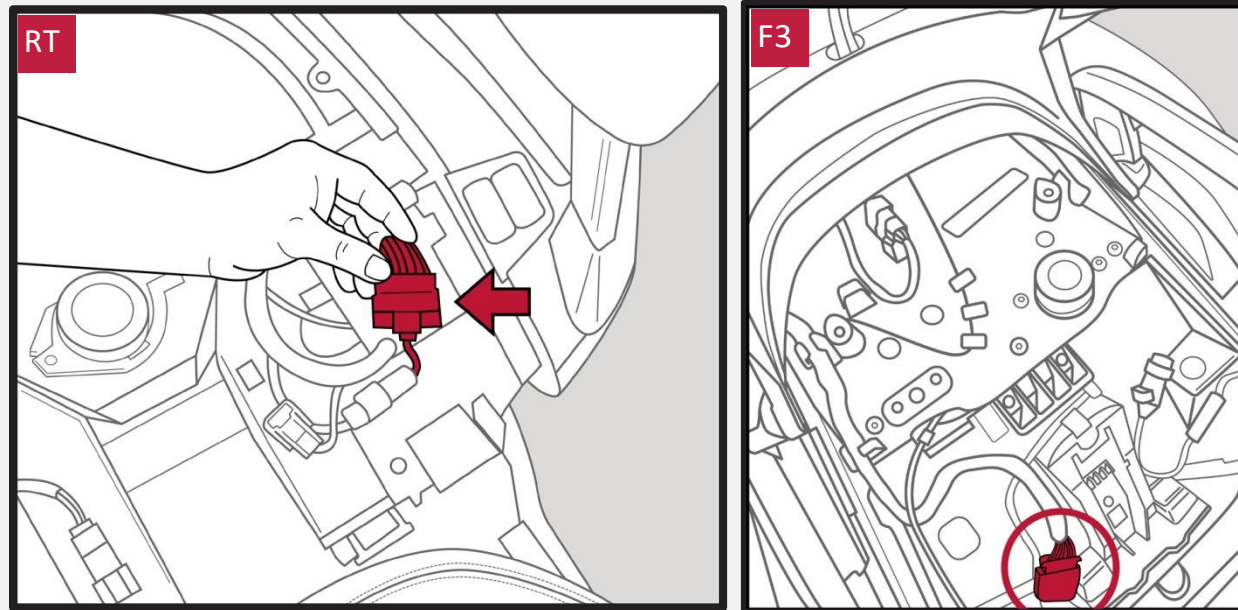

RT and F3: Locate the stock OEM tail harness location on the (left side for RTs) (right side for F3s) where the passenger seat is usually located.

Note for RTs: You might need to pull the tail harness into the outer surface as it may be tucked in the opening.

45

Unplug the stock OEM tail harness and plug in the Show Chrome's Plug N' Play Wire Harness in line to the stock OEM tail harness.

46

Using the extension harnesses provided; connect them in-line, to allow you to reach the connector without stressing the wiring, plug in connectors from trunk lights to the connectors from Show Chrome's Plug N' Play Wire Harness as follows:

1. The left trunk light extension harness connector plugs into the connector with a yellow-to-pink wire to the connector from Show Chrome's Plug N' Play Wire Harness.
2. The right trunk light extension harness connector plugs into the connector with a yellow-to- yellow wire to the connector from Show Chrome's Plug N' Play Wire Harness.

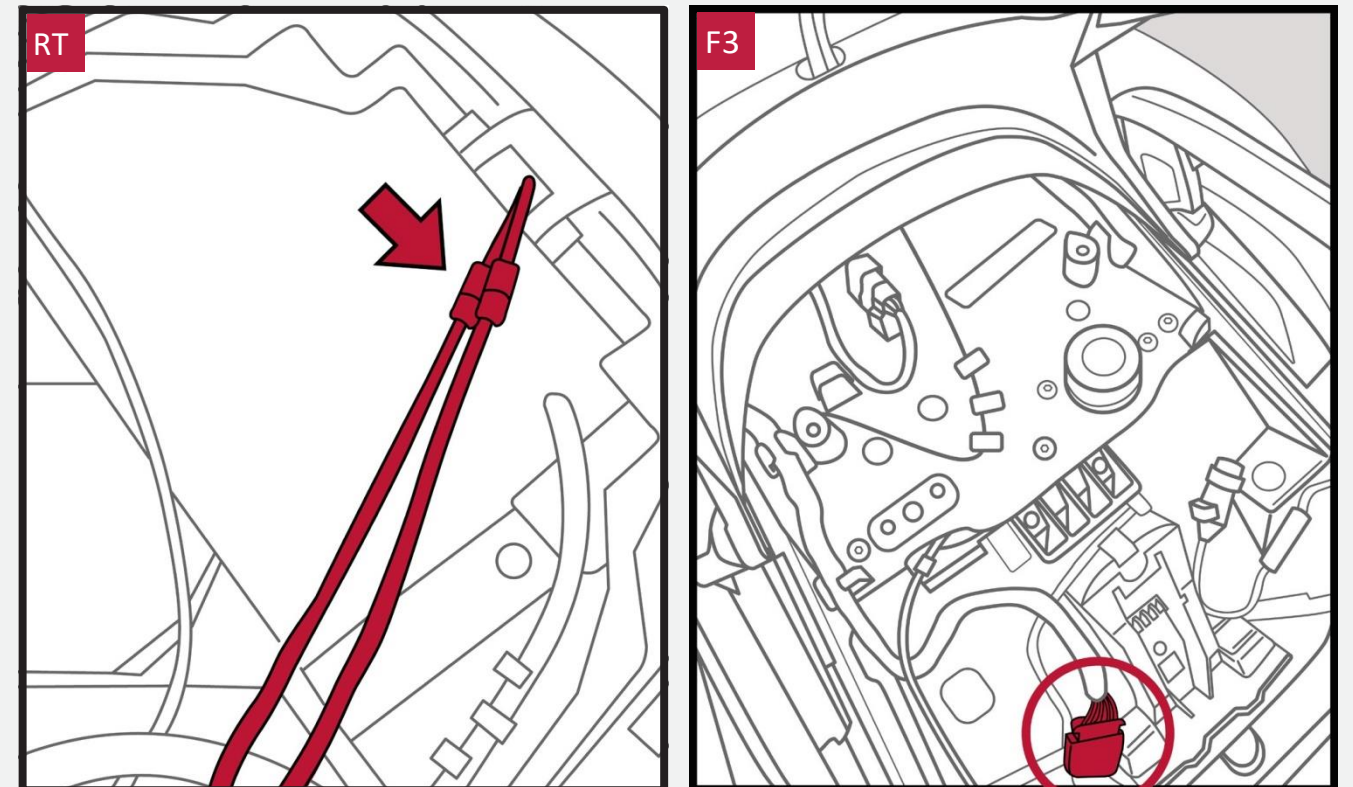

47

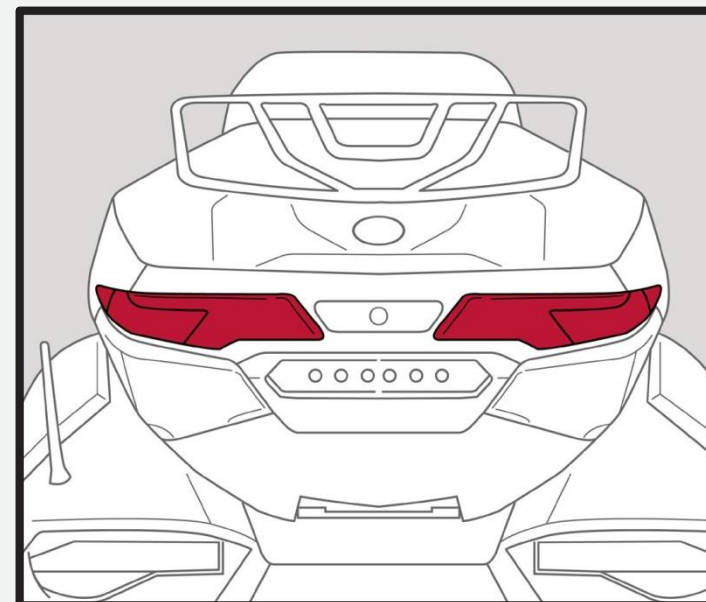

RT and F3: Test the trunk lights before putting the Spyder back together to verify the correct function.

NOTICE

This is an adhesive backed product. Caution must be taken during installation to properly position for one time placement. Repeat trials will result in failure of the adhesive.

NOTICE

Ignoring the contents of these instructions may affect the product performance and functionality. Not following these instructions may cause damage to the product or to the vehicle to which it is being attached.





 1-888-244-2453

 www.showchromeusa.com