

# BIG BIKE PARTS®

Copyright© 2023 by Big Bike Parts, Inc. No part of this instruction sheet may be reproduced without the written permission of Big Bike Parts, Inc.

Revised 5/5/2023

## INSTALLATION INSTRUCTIONS

PART NO. 52-797A

REMOVABLE SMART MOUNT™ BACKREST

FITMENT:

HONDA GL1800 GOLD WING 2001-2017

TOOLS NEEDED:	DRILL	9/32" DRILL BIT	6MM ALLEN WRENCH	1/8" ALLEN WRENCH	LINT-FREE CLOTH
	9" SERRATED KNIFE	UTILITY KNIFE	5MM ALLEN WRENCH	3/16" ALLEN WRENCH	RUBBING ALCOHOL
	MEASURING TAPE	7/16" WRENCH	4MM ALLEN WRENCH	13MM WRENCH	
HARDWARE INCLUDED:	BACKREST PAD	RUBBER STRIP	1/4-20 X 2-3/4" SOCKET HEAD CAP SCREW	M8 X 14MM BUTTON HEAD CAP SCREW (2)	
	PROTECTIVE COVER	M8 JAM NUT (2)	1/4-20 X 3" SOCKET HEAD CAP SCREW	1/4-20 NYLOCK NUT (2)	
	BOTTOM MOUNTING BRACKET		M6 LOCK WASHER (2)	M6 X 25MM SOCKET HEAD CAP SCREW (2)	

**NOTE: THREAD LOCK COMPOUND SHOULD BE USED ON ALL HARDWARE.**

**PLEASE READ THROUGH AND UNDERSTAND THESE INSTRUCTIONS BEFORE BEGINNING.**

**ESTIMATED INSTALLATION TIME: 60 TO 90 MIN.**

1. Park motorcycle on level surface and place on center stand.
2. Using a 6mm Allen Wrench, remove the 4 bolts in the passenger handles (2 in each handle). **See Diagram 1.**
3. Once handles are removed, lift seat (on models equipped with heated seat, a wiring harness will need to be disconnected on underside of seat) to remove.
4. Turn seat upside-down on a work surface, place Bottom Mounting Bracket (Y-shaped) on underside of seat, nesting curve of Bottom Mounting Bracket along curve of seat bottom. Attach Rubber Strip to Bottom Mounting Bracket in line with factory installed rubber rests. **See Diagram 2.**
5. Using Bottom Mounting Bracket as a template, mark locations of holes on seat base. **See Diagram 2.**
6. Remove Bottom Mounting Bracket to drill holes. Using a 9/32" bit, drill holes through white plastic seat base according to marked locations from step 5. **On models equipped with heated seat, care should be taken to avoid damaging seat warmer wires when drilling.**
7. After drilling holes, flip seat right-side up. Clean the upper driver's seat-back area with rubbing alcohol and a lint free cloth. **See Diagram 3.**
8. Locate centerline of seat (centerline should match up with the centerline stitching on the driver and passenger cushions). **See Diagram 3.**
9. Mark a location on seat-back top surface approximately 1-1/4" back from front seams along centerline of seat. **See Diagram 3.**
10. Align Protective Cover (Rubber gasket) and remove backing from double-sided tape to affix to seat at marked location. **See Diagram 3.**
11. With Protective Cover secured, use a utility knife to make a 1-1/2" wide slit in the vinyl seat covering. **See Diagram 3.**  
**Before proceeding, become familiar with steps 13-17 and accompanying Diagrams.**
12. Using a long, serrated knife (a bread knife works well), cut down through the slit, gently cutting through the foam. Angle of the cut should be approximately square to the driver's seat pad. The knife cut will create a guided path for the Top Mounting Bracket. **See Diagram 4. On models equipped with heated seat, care should be taken to avoid damaging the seat warmer wires when cutting, sharp edge of blade should face left, away from the wires.**
13. Push the knife down until it appears on the other side of the drilled holes in the seat base. Remove knife from seat.
14. Using a 4mm Allen Wrench, install the Backrest Assembly to the Riser Assembly using the 1/4-20 X 2-3/4" Socket Head Cap Screw and 1/4-20 Nylock Nut. Hand tighten. **See Diagram 5.**
15. Attach the riser assembly from step 14 to the Riser using the two M8 x 14mm screws as shown in **diagram 6**. Screw the screws in far enough so that the assembly is snug but you can still slide them apart. Install the M8 jam nuts on the back side to hold the screws from turning.
16. Push Riser down through the knife cut and guide through the path in seat foam until the M6 x 1.0 threaded holes in the Riser align with the drilled holes in seat bottom.
17. Place Bottom Mounting Bracket in same location as in step 4, aligning holes in the seat bottom with the tapped holes at the end of Riser. Using a 5mm Allen Wrench, attach the Bottom Mounting Bracket to Top Mounting Bracket through seat bottom by installing (2) M6-1.0 x 25mm Socket Head Cap Screws with (2) M6 Lock Washers.
18. To complete backrest installation, reinstall seat by reversing steps 2 and 3.
19. Move adjustment bracket to desired position and tighten all fasteners.

Diagram 1

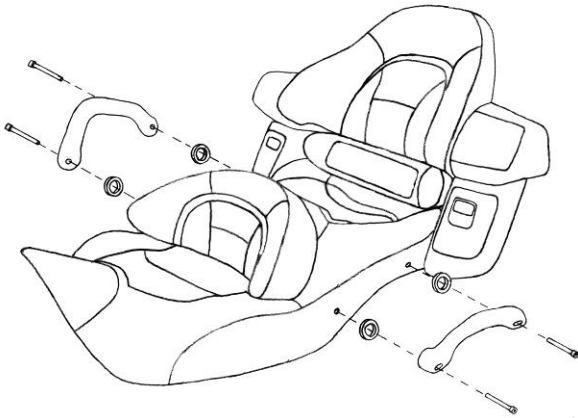

Diagram 2

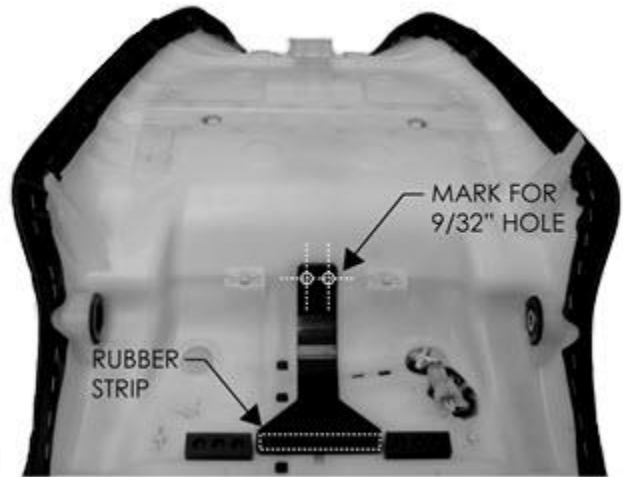

Diagram 3

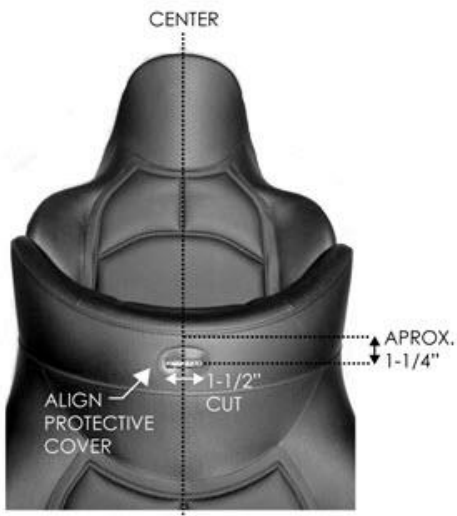

Diagram 4

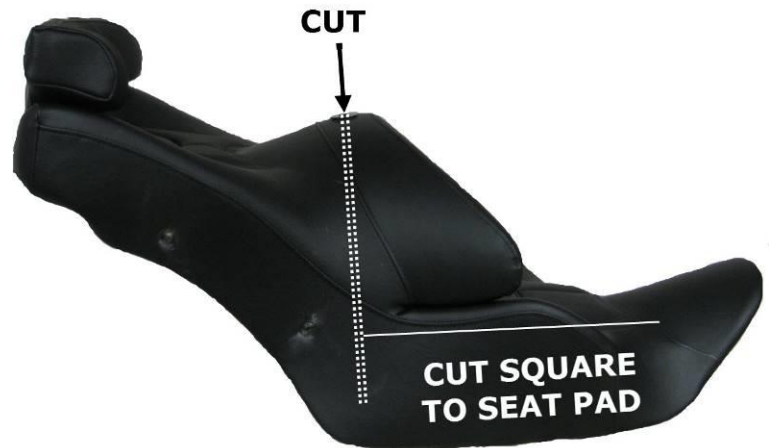
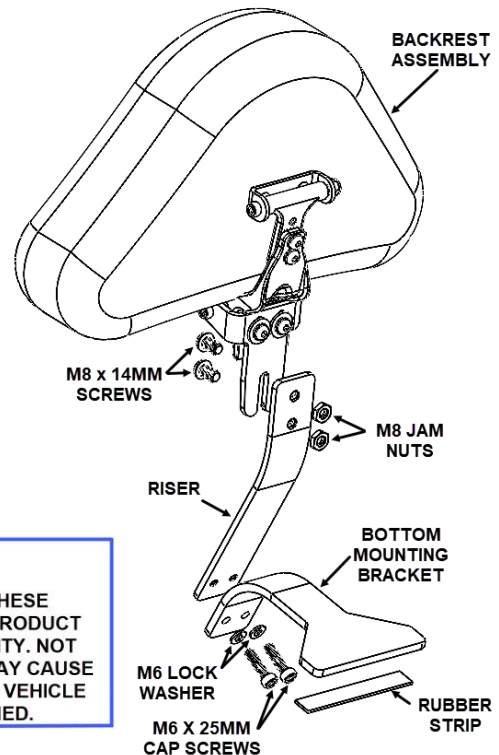

Diagram 5



Diagram 6



## WARNING

BACKREST IS DESIGNED TO SUPPORT RIDERS LOWER BACK WHEN RIDING. DO NOT APPLY EXCESSIVE FORCE BY PUSHING BACK WITH YOUR FULL BODY WEIGHT. DO NOT USE BACKREST TO LIFT OR SUPPORT MOTORCYCLE.

## NOTICE

IGNORING THE CONTENTS OF THESE INSTRUCTIONS MAY AFFECT THE PRODUCT PERFORMANCE AND FUNCTIONALITY. NOT FOLLOWING THESE INSTRUCTION MAY CAUSE DAMAGE TO THE PRODUCT OR THE VEHICLE TO WHICH IT IS BEING ATTACHED.