

# INSTALLATION INSTRUCTIONS

PART NO. 41-168A/ 41-168AG

REMOVABLE SMART MOUNT® BACKREST,  
GRANDE BACKREST

FITMENT:

CAN-AM SPYDER RT 2010-2019

<b>TOOLS NEEDED:</b>	DRILL SERRATED KNIFE TAPE MEASURE HACK SAW (2014-NEWER)	5/16" (8MM) DRILL BIT SHARP KNIFE 7/16" WRENCH PLIER (2014-NEWER)	10MM WRENCH 4MM ALLEN WRENCH 5MM ALLEN WRENCH 13MM WRENCH	1/8" ALLEN WRENCH 3/16" ALLEN WRENCH FINE POINT MARKER	LINT-FREE CLOTH RUBBING ALCOHOL SMALL FLAT SCREWDRIVER
<b>HARDWARE INCLUDED:</b>	BACKREST PAD BACKREST MOUNTING BRACKET REMOVABLE MOUNT BOTTOM MOUNTING BRACKET ADJUSTABLE TONGUE RUBBER STRIP	ADJUSTMENT PLATE ADJUSTING BRACKET PROTECTIVE COVER RISER M8 JAM NUT (2)	10-32 x 1/2" BUTTON HEAD SCREWS (2) 1/4-20 x 3" SOCKET HEAD SCREW (1) M6 x 14MM BUTTON HEAD SCREW (2) M6 x 18MM BUTTON HEAD SCREW (2) M6 x 25MM SOCKET HEAD SCREW (2)	1/4-20 x 2-3/4" SOCKET HEAD SCREW (1) 1/4-20 NYLOCK NUT (2) M6 LOCK WASHERS (6) M6 FLAT WASHERS (2) M8 X 14MM BUTTON HEAD SCREW (2)	

**PLEASE READ THROUGH AND UNDERSTAND THESE INSTRUCTIONS BEFORE BEGINNING. NOTE: THREAD LOCK COMPOUND SHOULD BE USED ON ALL HARDWARE.**  
**ESTIMATED INSTALLATION TIME: 60 TO 90 MIN.**

1. PLACE THE SPYDER RT ON A LEVEL SURFACE AND SET THE PARKING BRAKE.
2. OPEN THE SEAT AND UNPLUG THE SEAT HEATER IF EQUIPPED.
3. USING A SMALL FLAT SCREWDRIVER RELEASE THE CLIPS ON BOTH ENDS OF THE GAS SHOCK AND REMOVE THE SHOCK. SEE **DIAGRAM 1**.
4. CLOSE THE SEAT AND USING A 10MM WRENCH REMOVE THE 2 HINGE BOLTS FROM THE BACK OF THE SEAT. BE CAREFUL NOT TO LET THE SQUARE NUTS FALL INTO THE OPENINGS UNDER THE SEAT.
5. LIFT SEAT OFF AND LAY IT UPSIDE DOWN ON A CLEAN DRY TABLE OR WORK BENCH.
6. USING THE BOTTOM MOUNTING BRACKET AS A TEMPLATE, MARK THE LOCATION OF THE HOLES AS SHOWN IN **DIAGRAM 2**.
7. REMOVE THE BOTTOM MOUNTING BRACKET TO DRILL HOLES. USING A 5/16" (8MM) BIT, DRILL HOLES THROUGH THE BLACK PLASTIC SEAT BASE AT THE LOCATIONS YOU MARKED IN STEP 6. REMOVE ANY LOOSE PLASTIC AND SHARP EDGES FROM DRILLING.  
**NOTE: FOR 2014 AND NEWER MODELS GO TO "2014 AND NEWER" AT THE END OF THE INSTRUCTIONS.**
8. AFTER DRILLING THE HOLES, FLIP THE SEAT RIGHT SIDE UP. CLEAN THE UPPER DRIVER'S SEAT-BACK WITH RUBBING ALCOHOL AND A LINT FREE CLOTH AND LET DRY.
9. LOCATE THE CENTERLINE OF THE SEAT AS SHOWN IN **DIAGRAM 3**.
10. MARK A LOCATION ON THE SEAT AS SHOWN IN DIAGRAM 3 APPROXIMATELY 1-3/4" (45MM) BACK FROM THE TOP SEAM AND 1-1/4" (32MM) WIDE.
11. REMOVE THE BACKING FROM THE BLACK VINYL PROTECTIVE COVER THAT CAME IN THE KIT AND ADHERE IT TO THE SEAT CENTERED OVER THE MARKING YOU MADE IN STEP 10.
12. USING A SHARP KNIFE, CUT THE SEAT COVER ON THE LINE YOU MARKED IN STEP 10.
13. USING A LONG SERRATED KNIFE, CUT THROUGH THE HOLE IN THE SEAT COVER AIMING THE KNIFE AT THE APPROXIMATE ANGLE SHOWN IN **DIAGRAM 4**. TIP THE SEAT ON IT SIDE AND YOU SHOULD BE ABLE TO SEE THE TIP OF THE KNIFE THROUGH THE HOLES YOU DRILLED IN THE SEAT BOTTOM IN STEP 7.
14. MOVE THE KNIFE SIDE TO SIDE IN THE OPENING TO MAKE THE SLOT WIDE ENOUGH TO GET THE TOP RISER TO GO THROUGH IT.
15. USING A 4MM ALLEN WRENCH MOUNT THE ADJUSTMENT PLATE TO THE TOP REMOVABLE MOUNT AS SHOWN IN **DIAGRAM 5**.
16. ATTACH THE REMOVABLE MOUNT TO THE RISER USING THE TWO M8 X 14MM SCREWS AS SHOWN IN **DIAGRAM 6**. SCREW THE SCREWS IN FAR ENOUGH SO THAT THE REMOVABLE MOUNT AND THE RISER ARE SNUG BUT YOU CAN STILL SLIDE THEM APART. INSTALL THE M8 JAM NUTS ON THE BACK SIDE TO HOLD THE SCREWS FROM TURNING.
17. TAKE THE ASSEMBLY AND PUSH THE BOTTOM OF THE RISER INTO THE HOLE YOU CUT IN THE SEAT. LOOKING THROUGH THE HOLES YOU DRILLED IN THE SEAT BASE YOU WILL BE ABLE TO SEE THE 2 THREADED HOLES IN THE BOTTOM OF THE RISER.
18. TAKE THE BOTTOM MOUNTING BRACKET AND SET IT BACK INTO THE LOCATION WHERE YOU HAD IT TO MARK THE HOLES YOU DRILLED IN STEP 7.
19. INSTALL THE TWO M6-1.0 X 25MM LONG SOCKET HEAD CAP SCREWS AND TWO M6 LOCK WASHERS THROUGH THE BOTTOM BRACKET AND INTO THE THREADED HOLES IN THE RISER AND TIGHTEN. SEE **DIAGRAM 6**.
20. USING A 1/8" ALLEN WRENCH, ATTACH THE BACKREST MOUNTING BRACKET TO THE BACK OF THE BACKREST PAD WITH THE TWO 10-32 X 1/2" LONG BUTTON HEAD SCREWS. SEE **DIAGRAM 6**.
21. USING A 3/16" ALLEN WRENCH AND A 7/16" WRENCH, INSTALL THE ADJUSTABLE TONGUE TO THE TOP MOUNTING BRACKET WITH THE **BIG BIKE PARTS** STAMP FACING FORWARD USING THE 1/4-20 X 3" SOCKET HEAD CAP SCREW AND A 1/4-20 NYLOCK NUT. SEE **DIAGRAM 6**.
22. USING A 3/16" ALLEN WRENCH AND A 7/16" WRENCH, INSTALL THE ADJUSTING BRACKET TO THE BACKREST MOUNTING BRACKET WITH THE **BIG BIKE PARTS** FACING AWAY FROM THE PAD USING THE 1/4-20 X 2-3/4" SOCKET HEAD CAP SCREW AND A 1/4-20 NYLOCK NUT. SEE **DIAGRAM 6**.
23. USING A 4MM ALLEN WRENCH AND THE TWO M6-1.0 X 14MM LONG BUTTON HEAD SCREWS WITH LOCK WASHERS, ATTACH THE BACKREST PAD ASSEMBLY TO THE ADJUSTABLE TONGUE BRACKET AT THE DESIRED HEIGHT AND TIGHTEN. SEE **DIAGRAM 6**.
24. USING A 3/16" ALLEN WRENCH AND A 7/16" WRENCH ADJUST THE TWO 1/4-20 SOCKET HEAD CAP SCREWS SO THAT THE BACKREST IS AS TIGHT OR LOOSE AS YOU WILL LIKE IT FOR YOUR USE.
25. REINSTALL THE SEAT AND CONNECT THE WIRING FOR THE SEAT HEATER (IF EQUIPPED). YOU MAY NEED TO ADJUST THE LENGTH OF THE FRONT CONNECTING LUG (POST) ON YOUR SEAT TO MAKE THE SEAT LATCH.
26. ADJUST THE POSITION OF THE ADJUSTMENT PLATE TO GIVE YOU THE DESIRED POSITION OF THE BACKREST.
27. SNAP POUCH TO THE THREE SNAPS ON THE BACK OF THE BACKREST.

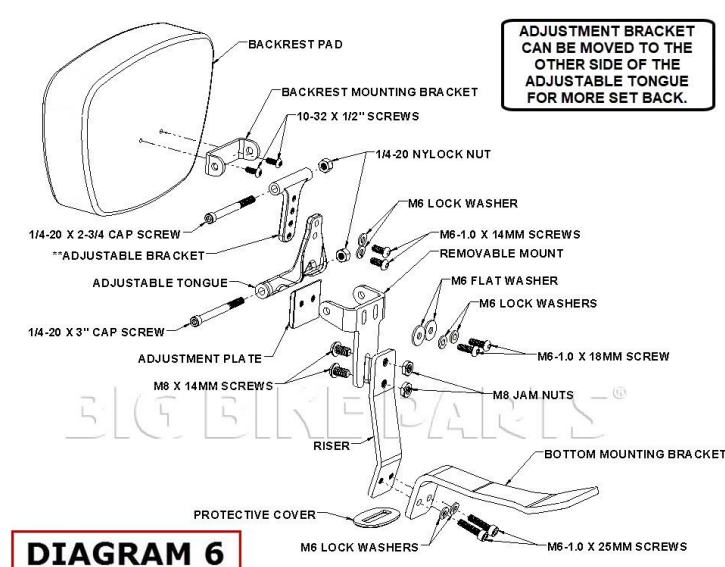
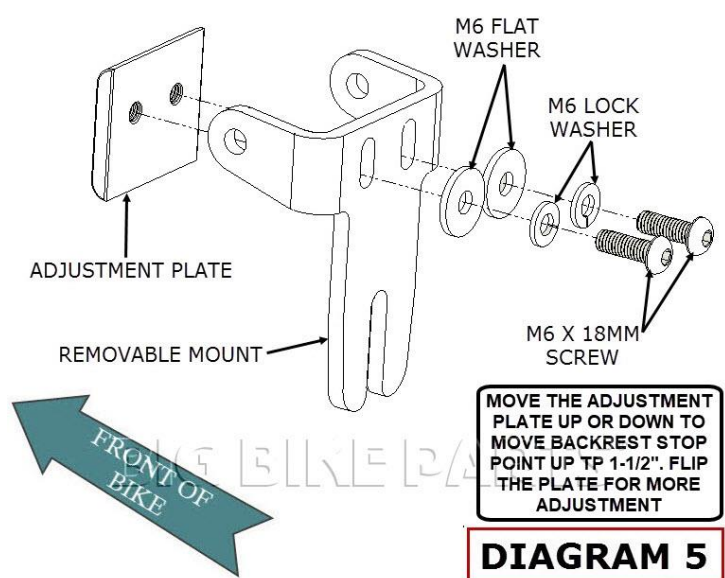
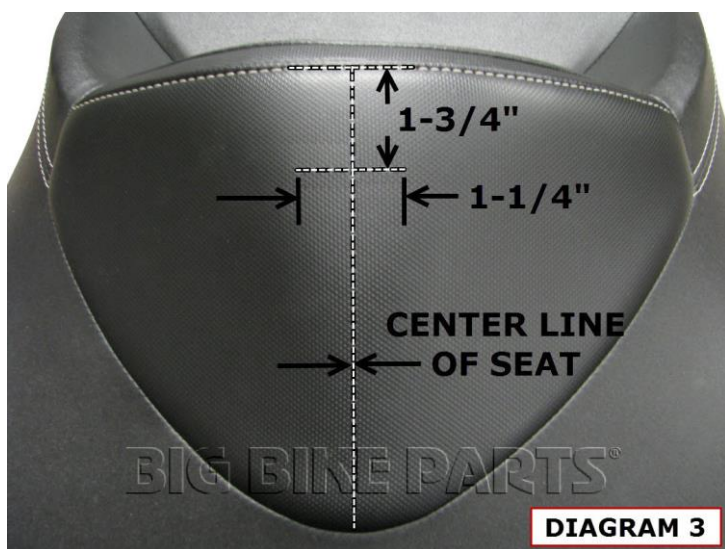
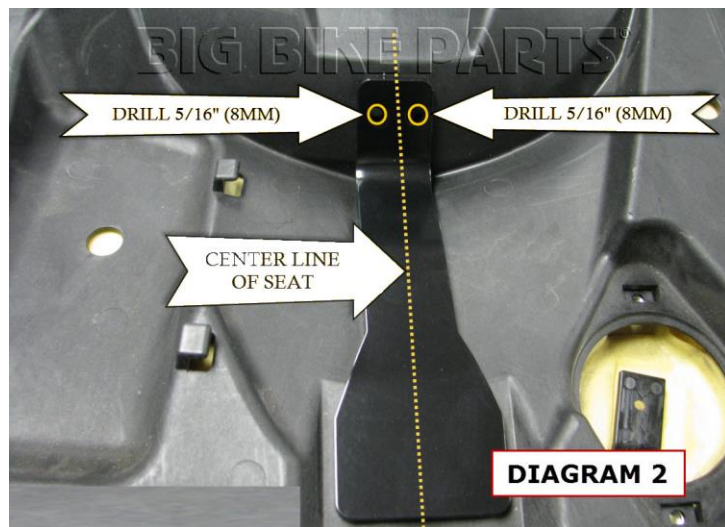
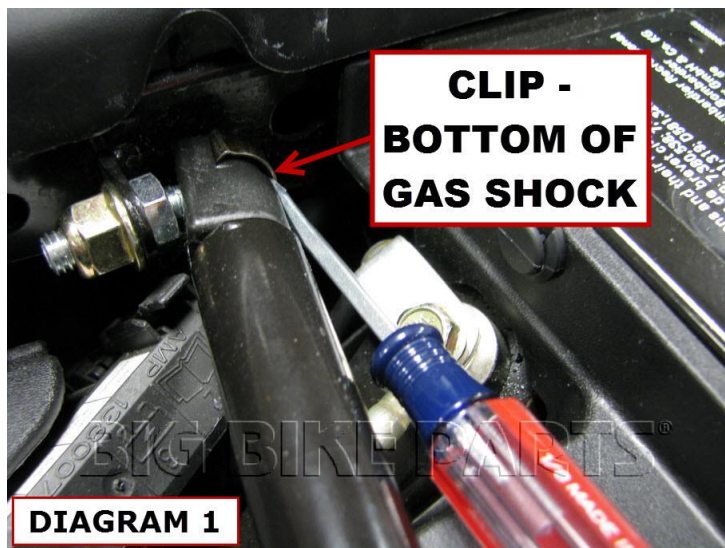



2014 AND NEWER

- A. USING A FLAT SCREWDRIVER REMOVE THE PLASTIC INSERT FROM THE TOP OF THE SEAT. SEE **DIAGRAM 7**.
- B. CUT THE CENTER RUBBER OUT OF THE CUTOUT AND REMOVE THE FOAM AS SHOWN IN **DIAGRAM 7**.
- C. APPLY MASKING TAPE TO THE TOP OF THE INSERT AND MARK AS SHOWN IN **DIAGRAM 8**.
- D. USING A HACK SAW CUT THE PLASTIC ON THE TWO SHORT LINES ON EACH SIDE.
- E. USING A SHARP KNIFE CUT ALONG THE LONG LINE PART WAY THROUGH THE PLASTIC.
- F. USING A PLIER BREAK PIECE OUT OF THE INSERT. SEE **DIAGRAM 9**.
- G. REINSTALL THE INSERT INTO THE SEAT.
- H. USE ALCOHOL AND CLEAN THE AREA AROUND THE HOLE IN THE INSERT AND LET DRY.
- I. REMOVE THE FILM FROM THE BACK OF THE PROTECTIVE COVER AND APPLY IT TO THE SEAT AS SHOWN IN **DIAGRAM 10**.
- J. GO BACK UP TO **STEP 15** AND COMPLETE THE ASSEMBLY OF THE DRIVERS BACKREST.

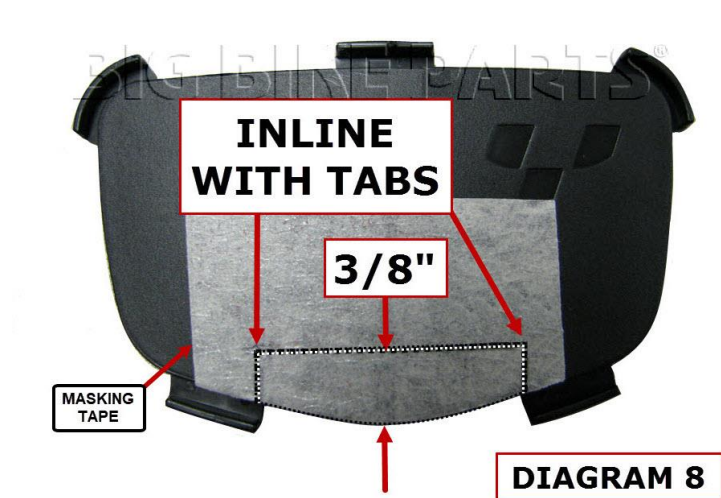

## WARNING

BACKREST IS DESIGNED TO SUPPORT RIDERS LOWER BACK WHEN RIDING. DO NOT APPLY EXCESSIVE FORCE BY PUSHING BACK WITH YOUR FULL BODY WEIGHT.

## NOTICE

IGNORING THE CONTENTS OF THESE INSTRUCTIONS MAY AFFECT THE PRODUCT PERFORMANCE AND FUNCTIONALITY. NOT FOLLOWING THESE INSTRUCTION MAY CAUSE DAMAGE TO THE PRODUCT OR THE VEHICLE TO WHICH IT IS BEING ATTACHED.