

BIG BIKE PARTS®

Copyright © 2021 by Big Bike Parts, Inc. No part of this instruction sheet may be reproduced without the written permission of Big Bike Parts, Inc.

INSTALLATION INSTRUCTIONS

PART NO. 41-409

REVERSE SHIFT COVER

FITMENT: CAN-AM RYKER 2019-NEWER

REVISED 7/16/2021

TOOLS NEEDED: T30 TORX

REMOVABLE THREAD LOCK

PLEASE READ THROUGH AND UNDERSTAND THESE INSTRUCTIONS BEFORE BEGINNING. USE REMOVABLE THREAD LOCK ON ALL HARDWARE.

ESTIMATED INSTALLATION TIME: 10 TO 15 MIN.

NOTICE

IGNORING THE CONTENTS OF THESE INSTRUCTIONS MAY AFFECT THE PRODUCT PERFORMANCE AND FUNCTIONALITY. NOT FOLLOWING THESE INSTRUCTION MAY CAUSE DAMAGE TO THE PRODUCT OR THE VEHICLE TO WHICH IT IS BEING ATTACHED.

INSTALLATION:

1. USING A T30 TORX, REMOVE THE SCREW FROM THE END OF THE REVERSE LEVER (FIG. 1). SCREW WILL NOT BE REUSED.
2. REMOVE THE OEM RUBBER PAD FROM THE REVERSE LEVER BY PULLING STRAIGHT OUT (FIG. 1).
3. PLACE A DROP OF REMOVABLE THREAD LOCK ON THE THREADS OF THE REVERSE LEVER. (FIG. 2).
4. SCREW THE REVERSE SHIFT COVER ON THE REVERSE LEVER (FIG. 3). LET THREAD LOCK CURE BEFORE USE.

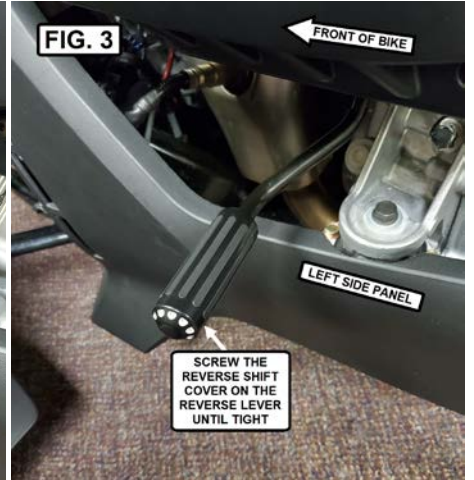
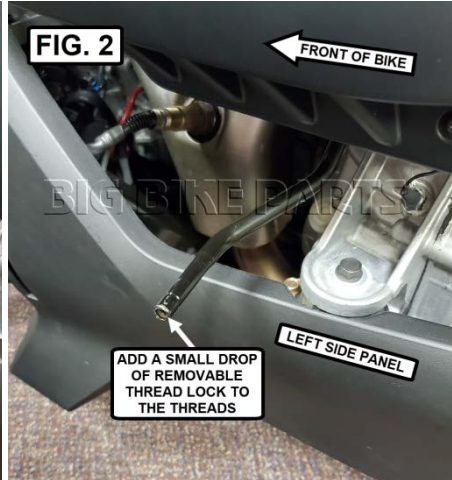
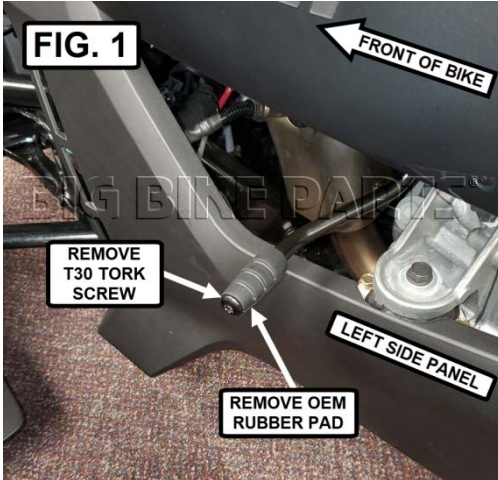

BIG BIKE PARTS®

Copyright © 2021 by Big Bike Parts, Inc. No part of this instruction sheet may be reproduced without the written permission of Big Bike Parts, Inc.

INSTALLATION INSTRUCTIONS

PART NO. 41-409

REVERSE SHIFT COVER

FITMENT: CAN-AM RYKER 2019-NEWER

REVISED 7/16/2021

TOOLS NEEDED: T30 TORX

REMOVABLE THREAD LOCK

PLEASE READ THROUGH AND UNDERSTAND THESE INSTRUCTIONS BEFORE BEGINNING. USE REMOVABLE THREAD LOCK ON ALL HARDWARE.

ESTIMATED INSTALLATION TIME: 10 TO 15 MIN.

NOTICE

IGNORING THE CONTENTS OF THESE INSTRUCTIONS MAY AFFECT THE PRODUCT PERFORMANCE AND FUNCTIONALITY. NOT FOLLOWING THESE INSTRUCTION MAY CAUSE DAMAGE TO THE PRODUCT OR THE VEHICLE TO WHICH IT IS BEING ATTACHED.

INSTALLATION:

1. USING A T30 TORX, REMOVE THE SCREW FROM THE END OF THE REVERSE LEVER (FIG. 1). SCREW WILL NOT BE REUSED.
2. REMOVE THE OEM RUBBER PAD FROM THE REVERSE LEVER BY PULLING STRAIGHT OUT (FIG. 1).
3. PLACE A DROP OF REMOVABLE THREAD LOCK ON THE THREADS OF THE REVERSE LEVER. (FIG. 2).
4. SCREW THE REVERSE SHIFT COVER ON THE REVERSE LEVER (FIG. 3). LET THREAD LOCK CURE BEFORE USE.

