

INSTALLATION INSTRUCTIONS

DRIVER BACKREST ASSEMBLY
PART # 52-637

FITS HONDA GL1800
GOLDWING 2001-NEWER

4/26/2017

ITEMS REQUIRED: 1/8" ALLEN WRENCH
3/16" ALLEN WRENCH
7/16" WRENCH
4MM ALLEN WRENCH
6MM ALLEN WRENCH

1. USING 7/16" WRENCH AND 3/16" ALLEN WRENCH ATTACH THE BACKREST TONGUE (1A) TO THE BACKREST TUBE (1B) WITH ONE 1/4" 20 X 3" SHCS (1C), TWO 1/4" FLAT WASHERS (1D) AND ONE 1/4" -20 NYLOC NUT (1E). THE WASHERS ARE TO GO TO THE INSIDE OF THE BRACKETS ON BACKREST TUBE (1B). TIGHTEN THE NUT (1E) UNTIL THERE IS A SLIGHT DRAG WHEN PIVOTING THE TONGUE (1A).
2. SLIDE THE TWO BACKREST TUBE COVERS (1F) ONTO THE BACKREST TUBE (1B).
3. USING THE 1/8" ALLEN WRENCH ATTACH THE "C" BRACKET (1G) WITH THE TWO #10-32 X 1/2" MACHINE SCREWS (1H) TO THE BACKREST PAD (1N).
4. USING THE 7/16" WRENCH AND 3/16" ALLEN WRENCH ATTACH THE BACKREST PAD (1N) WITH "C" BRACKET (1G) TO THE ADJUSTABLE TONGUE BRACKET (1P) WITH THE 1/4" -20 X 3" SHCS (1J) AND 1/4" -20 NYLOC NUT (1K). TIGHTEN THE BOLT (1J) UNTIL THERE IS A SLIGHT DRAG WHEN PIVOTING THE ADJUSTABLE TONGUE BRACKET (1P).
5. USING THE 4MM ALLEN WRENCH ATTACH THE BACKREST PAD ASSEMBLY TO THE ADJUSTABLE TONGUE (1A) WITH THE M6-1.0 X 12MM BUTTON SHCS (1Q) IN ANY LOCATION. THE ADJUSTABLE TONGUE CAN THEN BE RELOCATED, AFTER ASSEMBLY IS COMPLETE, FOR PREFERRED COMFORT LOCATION.
6. USING THE 6MM ALLEN WRENCH REMOVE THE ALLEN HEAD BOLTS (2A) ON BOTH RIGHT AND LEFT PASSENGER HAND GRIPS (2B). REMOVE THE HANDGRIPS.

WARNING

BACKREST IS DESIGNED TO SUPPORT RIDERS LOWER BACK WHEN RIDING. DO NOT APPLY EXCESSIVE FORCE BY PUSHING BACK WITH YOUR FULL BODY WEIGHT. DO NOT USE BACKREST TO LIFT OR SUPPORT MOTORCYCLE.

7. PLACE THE LEFT SIDE MOUNTING BRACKET (2C) AGAINST SEAT (2D). PLACE HANDGRIP (2B) BACK INTO PLACE. TIGHTEN DOWN USING THE NEW M8 X 1.25 X 75MM LONG ALLEN BOLTS (2A) PROVIDED. REPEAT STEP FOR THE RIGHT SIDE.
NOTE: IF USING WITH BIG BIKE PARTS ARMREST, THE ARMREST MOUNTING BRACKET GOES AGAINST THE SEAT. THE BOLT (2A) IS THE SAME AS THE ONE USED WITH BIG BIKE PARTS PASSENGER ARMREST.
8. SLIP THE KNURLED HAND ADJUSTMENT NUTS (1L) AND THE NYLON COLLARS (1M) ONTO THE ENDS OF THE ASSEMBLED BACKREST TUBE (1B).
9. SLIDE THE ASSEMBLED BACKREST TUBE (1B) ENDS INTO THE L/R MOUNTING BRACKETS (2C). HAND TIGHTEN THE ADJUSTMENT NUTS (1L) ONTO THE MOUNTING BRACKET THREAD UNTIL SNUG. IT MAY BE NECESSARY TO ALIGN THE ENDS OF THE BACKREST TUBE (1B) PARALLEL WITH THE MOUNTING BRACKETS (2C) IN ORDER TO START THE ADJUSTMENT NUTS (1L) ONTO THE THREADS. THIS CAN BE DONE BY CAREFULLY HAND BENDING THE BACKREST TUBE (1B) ENDS INWARD OR OUTWARD AS REQUIRED.

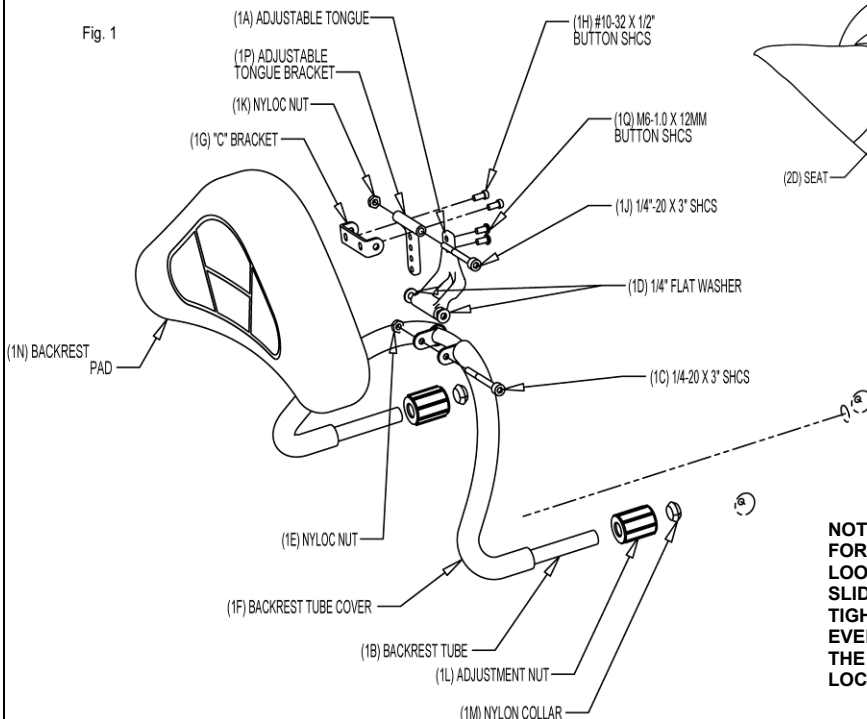
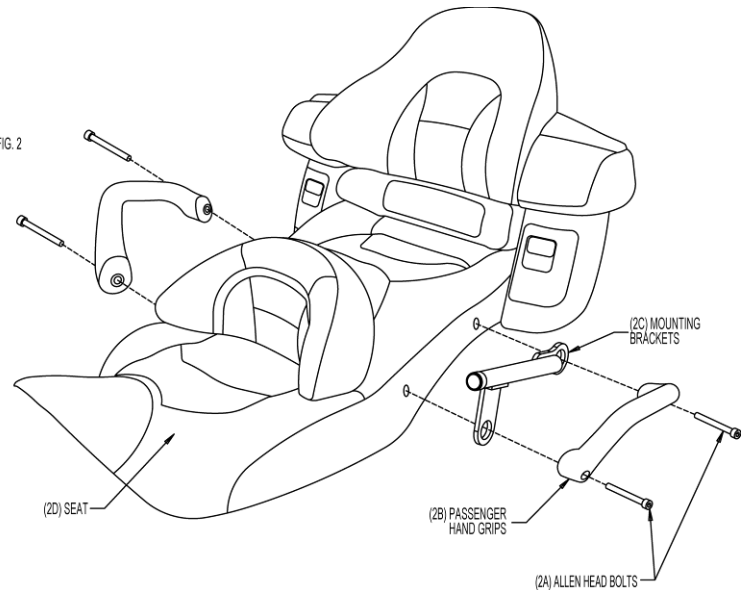

FIG. 2



NOTE: ADJUSTMENT OF THE BACKREST CAN BE ACCOMPLISHED FOR YOUR OWN COMFORT WHILE ON THE MOTORCYCLE BY LOOSENING THE KNURLED HAND ADJUSTMENT KNOBS (1L) AND SLIDING THE BACKREST TUBE (1B) FORWARD OR BACK AND RE-TIGHTENING THE ADJUSTMENT KNOBS (1L). IF THE BACKREST IS EVER REMOVED FROM THE MOUNTING BRACKETS, DO NOT LOSE THE NYLON COLLARS (1M) AS THEY ARE NECESSARY FOR LOCKING THE BACKREST INTO POSITION.