

Copyright © 2015 by Big Bike Parts, Inc. No part of this instruction sheet may be reproduced without the written permission of Big Bike Parts, Inc.

PART NO. 91-313

PASSENGER ARMRESTS

FITMENT: HARLEY-DAVIDSON FLH/FLT TOUR PAK 2014-NEWER

Revised 7/7/2022

TOOLS NEEDED: 3/32" ALLEN WRENCH

1/4" ALLEN WRENCH

PHILLIPS SCREWDRIVER

7/16" WRENCH

**PLEASE READ THROUGH AND UNDERSTAND THESE INSTRUCTIONS BEFORE BEGINNING. USE REMOVABLE THREAD LOCK ON ALL FASTENERS.**

**ESTIMATED INSTALLATION TIME: 30 TO 60 MIN.**

## INSTALLATION:

1. UNPLUG ANY WIRING CONNECTORS AND CABLES LEADING TO THE BIKES TRUNK. (i.e. lights, audio, antenna)
2. USING A 7/16" WRENCH REMOVE THE FOUR NUTS AND WASHER THAT ARE ON THE BOTTOM SIDE OF THE TRUNK MOUNT. SEE FIG. 1.
3. PLACE THE ARMREST BASE ON THE FRONT OF TRUNK MOUNT AND ALIGN THE SLOTS IN THE ARMREST BASE WITH THE SLOTS IN THE MOUNT.
4. FIG. 2A SHOWS INSTALLING THE ARMRESTS ON A NON-REMOVABLE TRUNK MOUNT.
5. FIG. 2B SHOWS INSTALLING THE ARMRESTS ON A DETACHABLE TRUNK MOUNT.
6. USING FIG. 2A OR 2B INSTALL TWO OF THE LARGE WASHER/SPACERS WITH THE FLAT HEAD SCREWS AND LOCK NUTS.
7. USING A PHILLIPS SCREWDRIVER AND A 7/16" WRENCH TIGHTEN BOTH SCREWS. *NOTE: BE SURE TO KEEP THE SLOTS ALIGNED AS YOU TIGHTEN THEM.*
8. TAKE THE OTHER TWO LARGE FLAT WASHERS AND PLACE THEM ON THE TRUNK MOUNT AS SHOWN IN FIG. 3.
9. REINSTALL THE TRUNK WITH THE LARGE WASHER IN BETWEEN THE TRUNK AND THE MOUNT.
10. INSTALL THE FOUR WASHERS AND NUTS AND TIGHTEN.
11. RECONNECT ANY WIRING AND CABLES YOU DISCONNECTED IN STEP 1.
12. REMOVE BOTH ARMREST ARMS FROM THE KIT AND USING FIG. 4 DETERMINE WHICH ARM IS FOR THE RIGHT SIDE.
13. USING FIG. 5 ASSEMBLE THE RIGHT SIDE ARMREST BUT DO NOT TIGHTEN THE SET SCREW.
14. USING A 1/4" ALLEN WRENCH TIGHTEN THE 5/16" X 2" ALLEN BOLT SO THAT THE ARMREST PIVOT HAS SOME RESISTANCE. KEEP THE WRENCH IN THE BOLT WHEN SETTING THE RESISTANCE SO THAT THE BOLT DOES NOT MOVE.
15. WITHOUT MOVING THE ARMREST INSTALL THE SET SCREW AND TIGHTEN IT WITH A 3/32" ALLEN WRENCH.
16. REPEAT STEPS 13 THROUGH 15 ON THE LEFT SIDE.

*NOTE: YOU MAY NEED TO READJUST RESISTANCE AFTER SOME USE.*

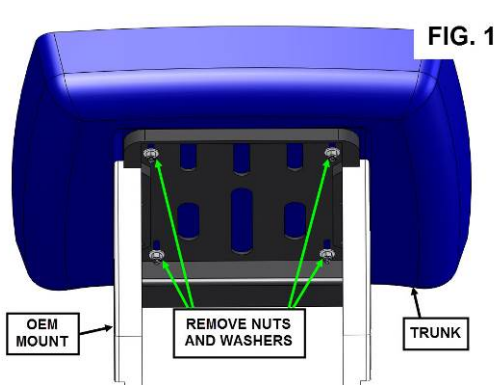

FIG. 1

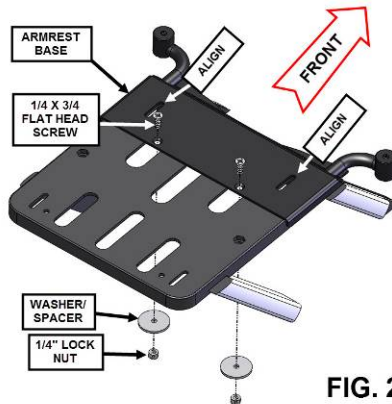

FIG. 2A

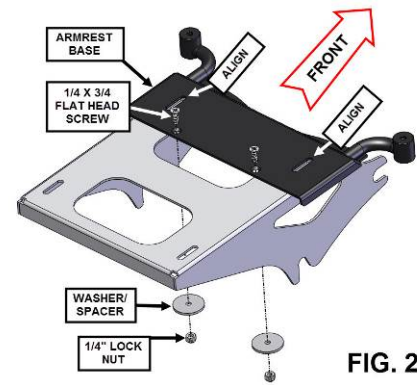

FIG. 2B

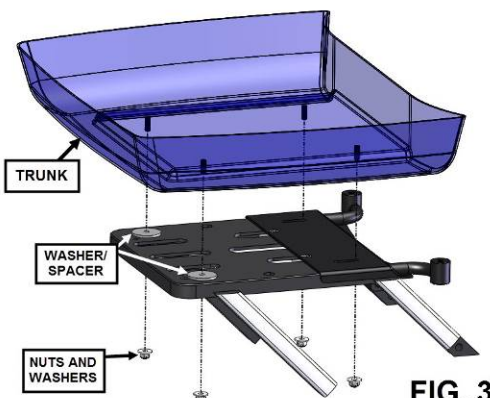

FIG. 3

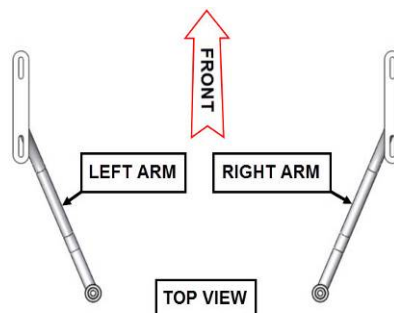

FIG. 4

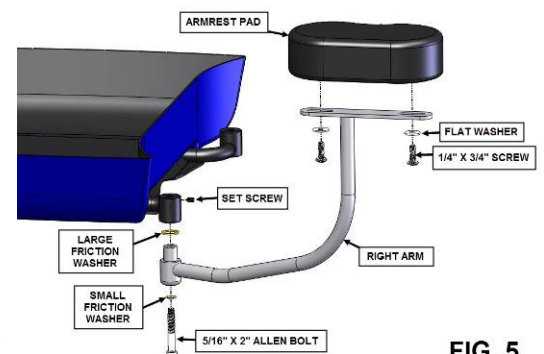

FIG. 5