

Copyright© 2017 by Big Bike Parts, Inc. No part of this instruction sheet may be reproduced without the written permission of Big Bike Parts, Inc.

PART NO. H40-303BK

LOWER MINI BRA EXTENSION

9/7/2017

FITMENT:

CAN-AM SPYDER F3 (ALL) 2015-NEWER

TOOLS NEEDED:

TAPE MEASURE

RUBBING ALCOHOL

T25 TORX DRIVER

FLAT SCREWDRIVER

REMOVABLE THREAD LOCK

RAZOR KNIFE

CLEAN RAG/TOWEL

PLEASE READ THROUGH AND UNDERSTAND THESE INSTRUCTIONS BEFORE BEGINNING. USE A REMOVABLE THREAD LOCK ON ALL SCREWS.

ESTIMATED INSTALLATION TIME: 20 TO 45 MIN.

INSTALLATION:

1. OPEN THE FRONT TRUNK AND REMOVE THE SERVICE PANEL SHOWN IN FIG. 1.
2. REMOVE THE TWO TOP SERVICE PANELS SHOWN IN FIG. 2.
3. USING A FLAT SCREWDRIVER PRY THE CENTER UP OF EACH PLASTIC PIN SHOWN IN FIG. 3 REMOVE THE PINS. THERE ARE 6 PINS TOTAL 3 ON EACH SIDE.
4. USING A T25 TORX DRIVER REMOVE THE SCREWS HOLDING THE SIDE PANELS TO THE F3. SEE FIG. 4 AND 5. LIFT EACH SIDE PANEL OFF.
5. STARTING WITH THE RIGHT SIDE PANEL MARK THE GRAY FOAM ON THE INSIDE OF THE PANEL AS SHOWN IN FIG. 6.
6. USING A RAZOR KNIFE CUT THROUGH THE FOAM TO THE PLASTIC ON THE LINES YOU JUST MARKED.
7. REMOVE THE TWO PIECES OF FOAM AS SHOWN IN FIG. 7. ALSO REMOVE ANY CLUE AND CLEAN THE AREAS WITH RUBBING ALCOHOL. LET DRY.
8. USING FIG. 8 DETERMINE WHICH BRA IS FOR THE RIGHT SIDE. REMOVE THE TWO PIECES OF HOOK FROM THE BRA.
9. PLACE THE 8" PIECE OF HOOK FLAT ON THE PANEL AS SHOWN IN FIG. 7. PLACE THE 2-1/2" PIECE ON THE INSIDE EDGE AS SHOWN IN FIG. 7.
10. ATTACH THE NARROW SIDE OF THE RIGHT BRA TO THE 2-1/2" HOOK FIRST. THEN PULL TIGHT AND ATTACH THE 8" SIDE.
11. REINSTALL THE PANEL IN REVERSE ORDER AND ADJUST BRA AS NEEDED.
12. REPEAT STEPS 8-11 FOR THE LEFT SIDE.
13. LET TAPE CURE FOR 24 HOURS BEFORE USE.

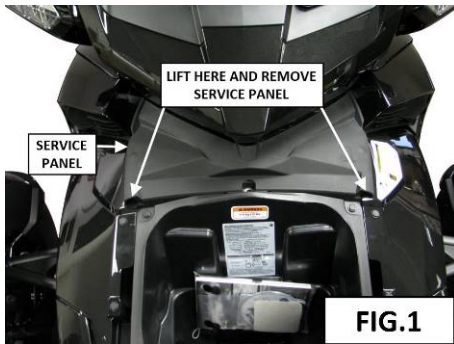

FIG. 1

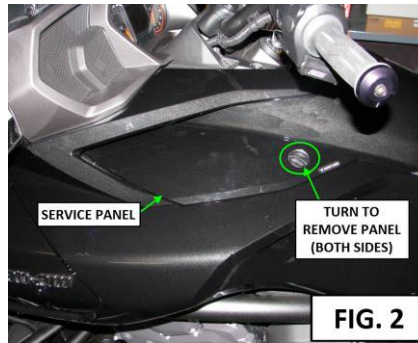

FIG. 2

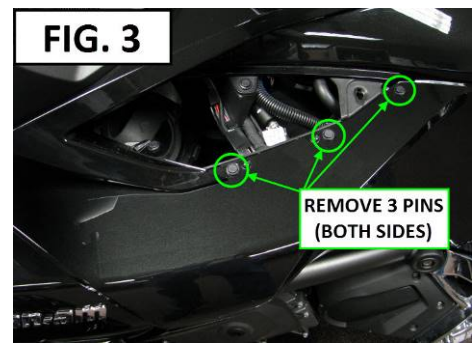

FIG. 3

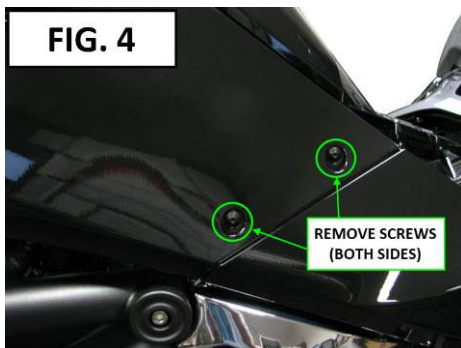

FIG. 4

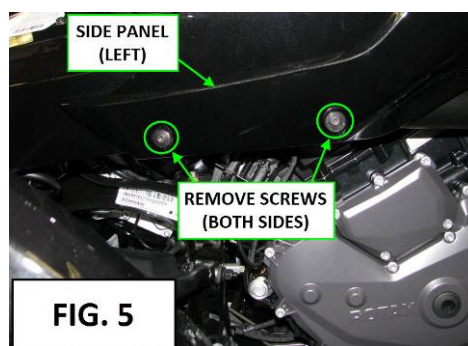

FIG. 5

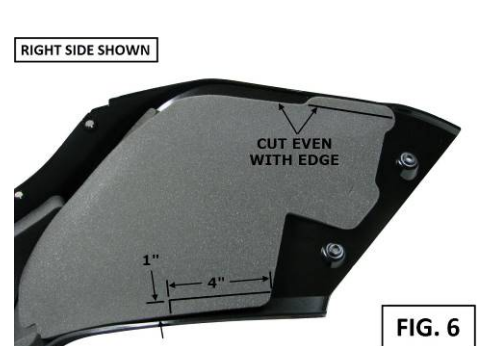

FIG. 6

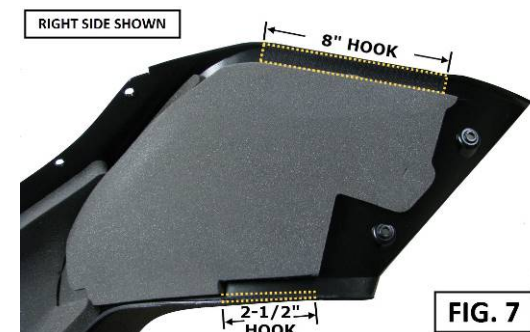

FIG. 7



FIG. 8